

HISTORIC · MARYVILLE

The Baldwin

DRIVE UNDER

1,576 SQUARE FEET · 3 BEDROOMS · 2.5 BATHROOMS



A



C



AVENUE



OF OAKS

The Baldwin Drive Under

| | |
|------|-------------|
| 1576 | SQUARE FEET |
| 3 | BEDROOMS |
| 2.5 | BATHROOMS |

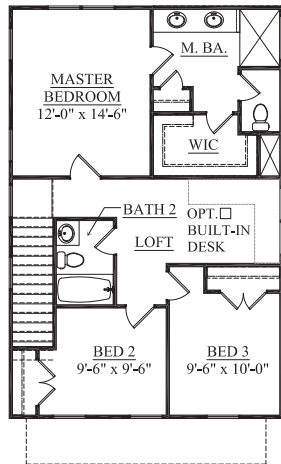

Second Floor Plan
ELEVATION A

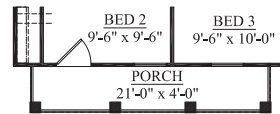
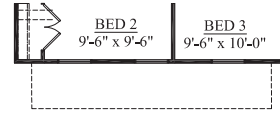

Partial Second Floor Plan
ELEVATION C

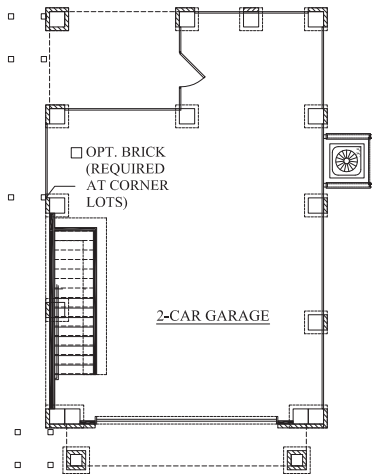

Ground Floor Plan

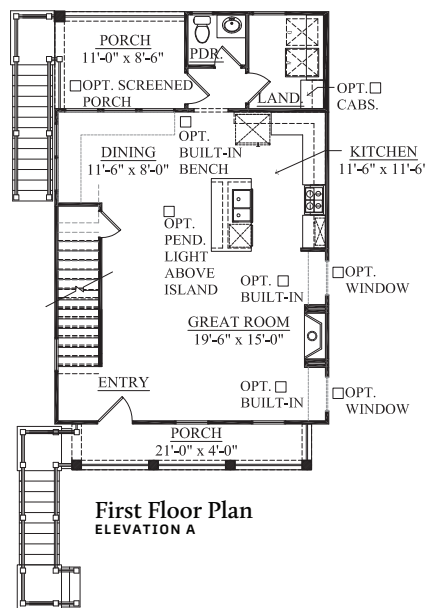

First Floor Plan
ELEVATION A

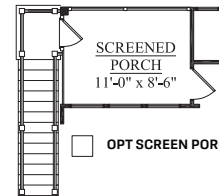

Partial First Floor Plan
ELEVATION C

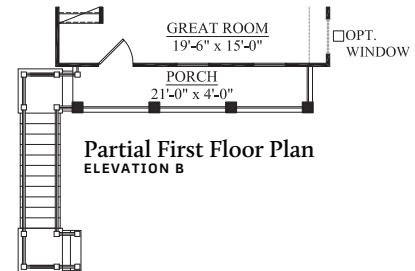
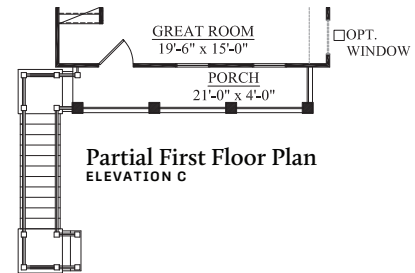

Partial First Floor Plan
ELEVATION B

CrescentHomes.net | 843.466.5000



AVENUE  OF OAKS

Dimensions and square footage are approximate. Elevations shown are artist's concepts. Optional features reflected in floor plan. Floor plans may vary per elevation. Crescent Homes reserves the right to make changes without notice or prior obligation.



REV.
05.06.21