

THE PALMETTO SERIES

FENWICK II



1,855 SQUARE FEET | 3 BEDROOMS | 2 BATHROOMS



SHOWN WITH OPTIMAL DORMER AND METAL ROOF **C**



A



B

SHOWN WITH OPTIONAL DORMER AND METAL ROOF

RAILING PER CODE ON ALL ELEVATIONS



[CRESCENTHOMES.NET](https://www.crescenthomes.net)

CHS 843.466.5000 | GVL 864.406.5000 | NVL 615.392.5000

CRESCENT
HOMES

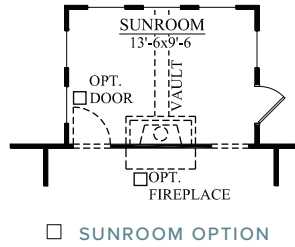

SUNROOM OPTION

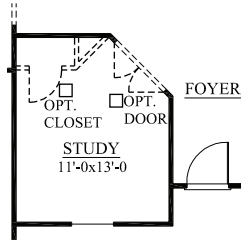

STUDY OPTION

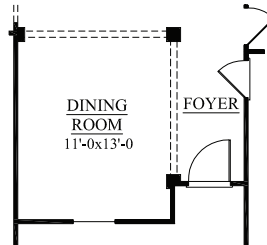

DINING ROOM OPTION

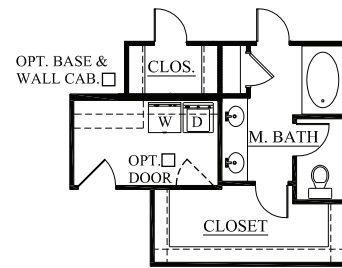

OPT. LAUNDRY WITH STANDARD BATH LAYOUT

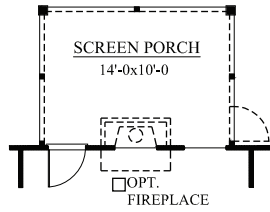

SCREEN PORCH OPTION

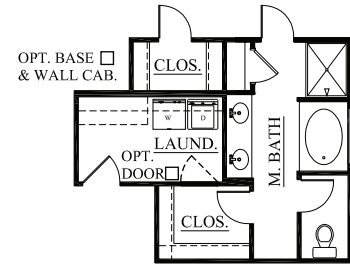

OPT. LAUNDRY WITH DELUXE MASTER BATH OPT. 2

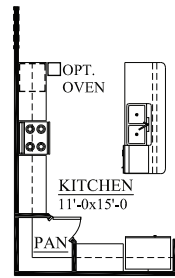

KITCHEN OPTION

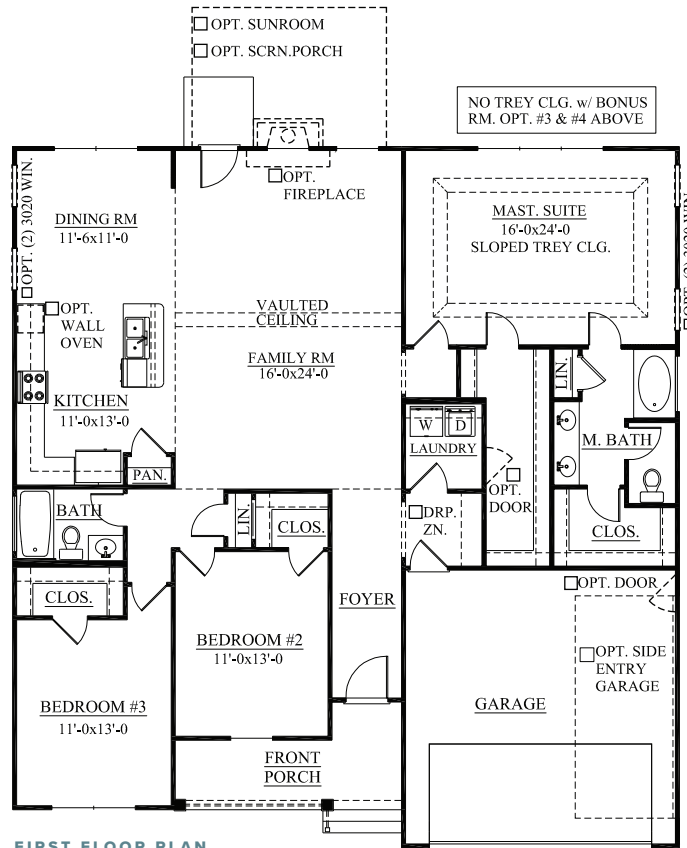

FIRST FLOOR PLAN

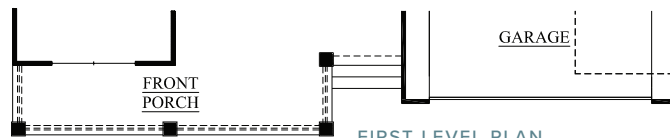

FIRST LEVEL PLAN ELEVATION C

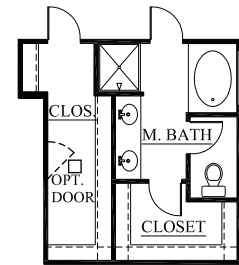

DELUXE MASTER BATH OPT. 1

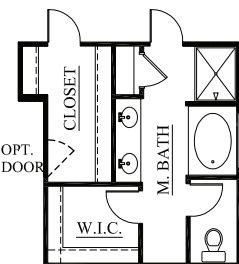

DELUXE MASTER BATH OPT. 2

REV. 5.19.21

Dimensions and square footage are approximate. Elevations shown are artist's concepts. Optional features reflected in floor plan. Floor plans may vary per elevation. Crescent Homes reserves the right to make changes without notice or prior obligation.



CRESCENTHOMES.NET

CHS 843.466.5000 | GVL 864.406.5000 | NVL 615.392.5000

CRESCENT HOMES