

# NORTHRIDGE

Standard Features

## CABINETS

Upper Cabinet Style: Staggered Uppers or 42" Uppers

Island included: per plan



### Oak Cabinets



Island Support Corbel

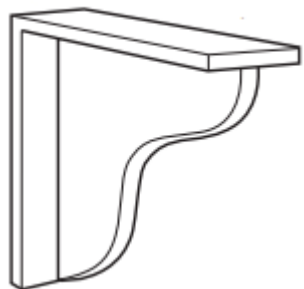

Base Cabinet Set-Up: Drawer and cabinet box w/half shelf

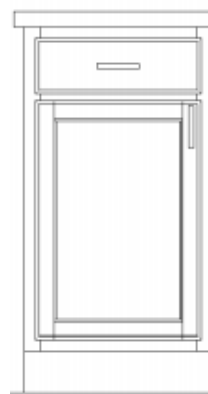

## APPLIANCES

\*Fieldstone Homes reserves the right to remove or replace standard options at any time without notice

## COUNTERTOPS

**Included backsplash: 4" tall backsplash that matches countertop. Tile backsplashes are available as an upgrade option**

**2cm Granite: Included in the kitchen**

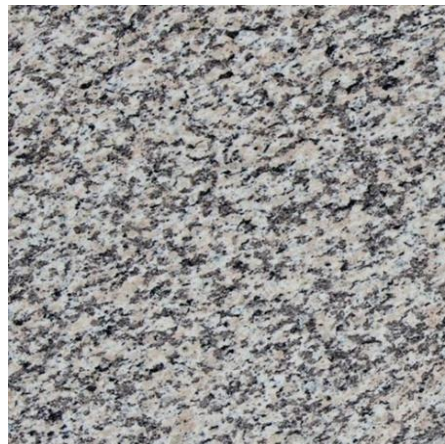



## COUNTERTOPS

Laminate: Included in bathrooms

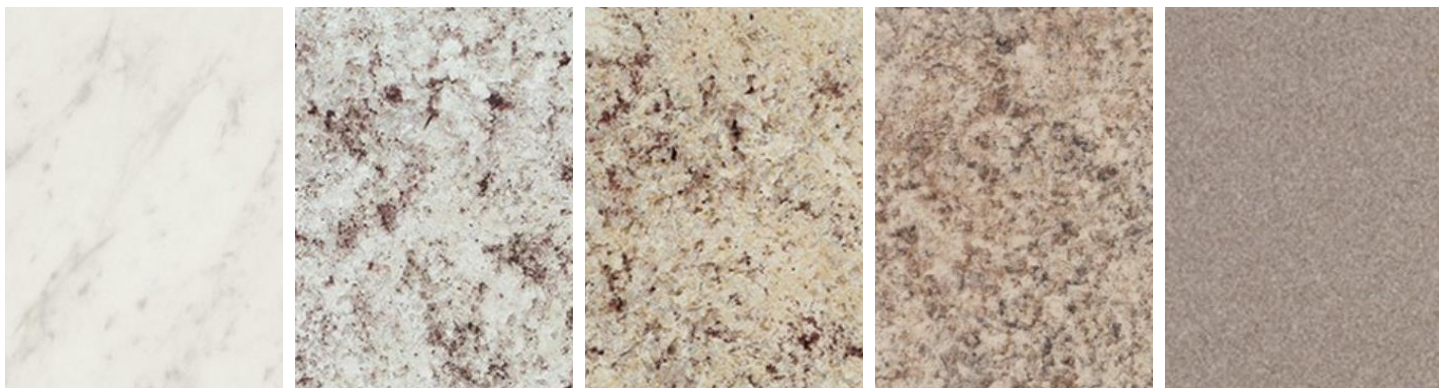

Included laminate edge: waterfall

Appliance package includes range, dishwasher, and micro-hood. Included package: electric in black or white



\*Fieldstone Homes reserves the right to remove or replace standard options at any time without notice

## KITCHEN SINKS

Undermount stainless steel sinks: included with all granite/quartz countertops:



5050 / 6040

## BATHROOM SINKS

Drop-in round white: included with all laminate countertops



## PLUMBING

**Kitchen Faucet: Moen / Integra / Chrome**



**Bathroom plumbing fixtures:**



**Sink faucets / Shower head & tub/shower combo**

## MASTER SHOWER ENCLOSURES

**\*\*Size may vary per plan: Smooth Cultured Marble Walk-In Shower/ No Tub\*\***

***\*Metal trim included is chrome. Bronze (shown) & Brushed Nickel are optional\****





## SECONDARY BATH ENCLOSURES



**Tub/Shower combo with fiberglass surround**

## FINISH TRIM

Baseboards & trim included style: Craftsman or Traditional

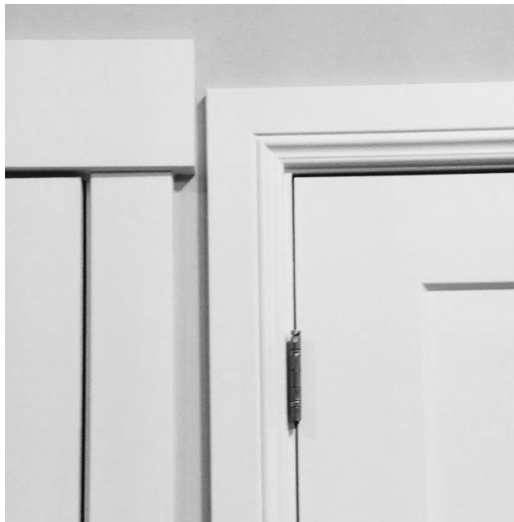

Large base and case

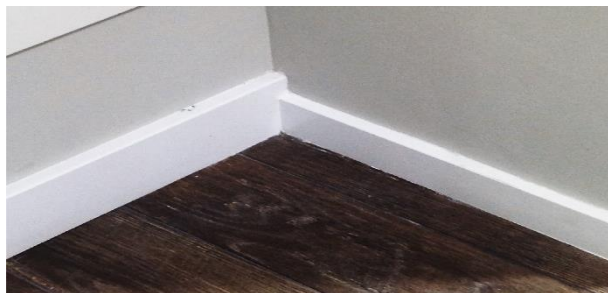

Craftsman / Traditional

Included Window Style is Drywall Wrapped: Wood Painted Window Sills are an Upgrade



## FLOORING

Laminate included in entry, kitchen, nook, mudroom, pantry, powder bath



## FLOORING

Floorte included in wet areas (full bathrooms & laundry)





## FLOORING

Carpet w/6 LB pad included



## PAIN**T**

**Two-tone paint included. Walls and ceiling are painted one color with an eggshell finish:**

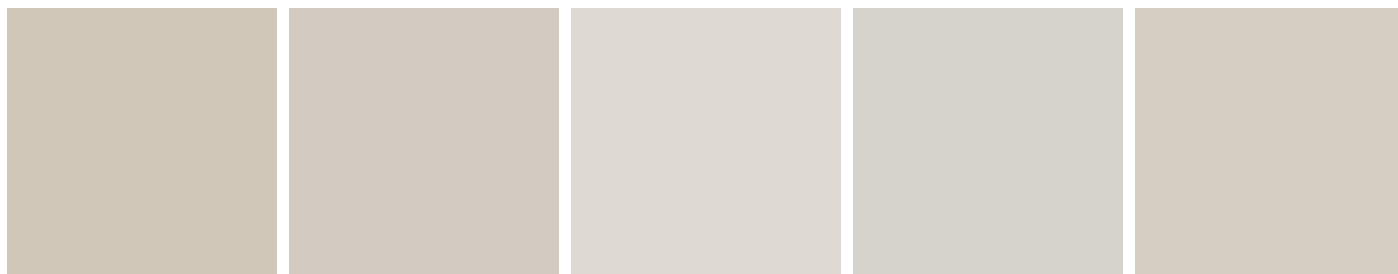

**Doors & Trim are painted with a semi-gloss finish:**

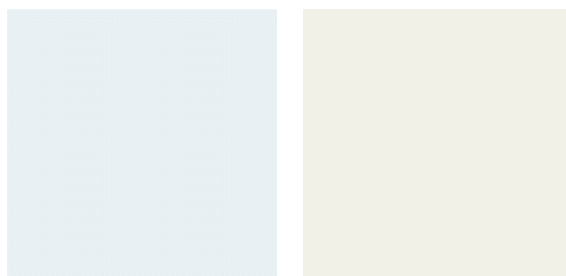

## ELECTRICAL

**\*\*Exact plates may differ from images below\*\***



Toggle Light Switches / Duplex Outlets

## LIGHTING

### 3 Bulb flush mount ceiling lights



Brushed nickel / Oil rubbed bronze

### 3 Bulb bathroom vanity lights. (1) fixture over each sink



Chrome / Brushed nickel / Oil rubbed bronze



## HARDWARE

Included interior knobs. Bathroom and master bedroom doors will have a lock



Brushed nickel / Oil rubbed bronze

Exterior doors include a keyed knob with round deadbolt. \*SGD will have a specific locking mechanism\*





Brushed nickel / Oil rubbed bronze

Bathroom hardware: towel rings, towel bars, & toilet paper holders:



Included in chrome

## EXTERIOR DOORS

Front Door	Garage service and entry door (door between garage and mudroom)
	
2 Panel Square Top / 2 Panel Arch Top	6 Panel Raised <i>*Only door available at this location</i>

## INTERIOR DOORS



2 Panel Square Top / 2 Panel Arch Top

## EXTERIOR COLORS

Main color and stone color cannot be the same as next door neighbors or neighbors across the street. Buyer may choose up to (3) colors: Main, Accent, and Trim

Front//back/sides material: James Hardie. Main & Accent color options: per plan/per lot

Some homes will require stone & stucco: per plan/per lot

### Siding and Battens Color Offering



### Trim Color Offering





### Exterior Stone:





## Shingles:



Included Exterior Coach Lights:

On either side of garage door(s) & by front door	Rear doors and garage service door
 <p data-bbox="363 936 544 968">Black / Bronze</p>	 <p data-bbox="1078 932 1258 963">Black / Bronze</p>

## GARAGE DOORS

Included garage doors styles:

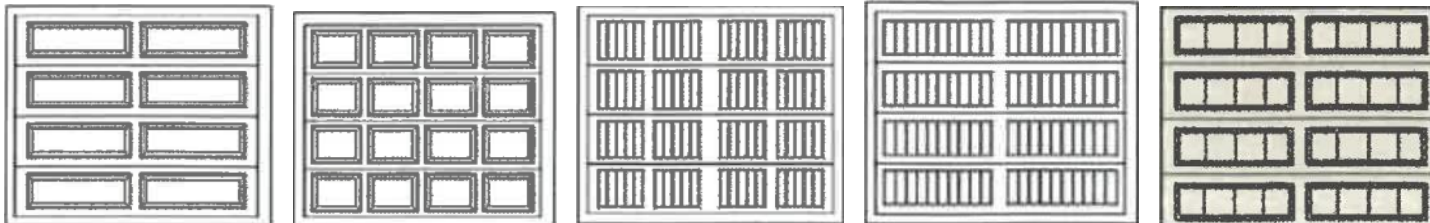

## GARAGE DOOR COLORS



## MECHANICAL

Number of included furnaces vary per plan. Furnaces are sized to match finished square footage. Included furnace is an 80% efficiency furnace with a 13-SEER AC unit. Upgrades are available in HomeFitting.

## MIRRORS

All bathrooms come with mirrors sized to match the vanity. Mirrors are mounted to the wall with clips. Mirror frames are available as an upgrade in HomeFitting.

## WINDOWS

Double paned low-E windows included.

## INSULATION

Attic: R-44 Blown-in insulation included

Exterior walls: R-19 Roll & Batt insulation on all exterior walls (except garage)

Insulated garage doors and exterior garage walls can be added as an option in HomeFitting.

- FULL "COLOR PLUS" HARDIE EXTERIOR. SOME LOTS WILL REQUIRE STUCCO/STONE.

\*Fieldstone Homes reserves the right to remove or replace standard options at any time without notice

## Northridge | Standard Options

- LEVEL 0 CABINETS
- KITCHEN ISLAND: PER PLAN
- STAGGERED OR 42" UPPER KITCHEN CABINETS W/ CROWN MOLDING
- 60" SINGLE SINK VANITY @MASTER
- LEVEL 0 2CM GRANITE @KITCHEN
- LAMINATE COUNTERTOPS @BATHROOMS
- UNDERMOUNT KITCHEN SINK
- LEVEL 1 ELECTRIC (B/W) APPLIANCE PACKAGE
- WALK-IN WHITE SMOOTH CULTURED MARBLE SHOWER @ MASTER
- TUB/SHOWER COMBO WITH FIBERGLASS SURROUND @SECONDARY BATHROOMS
- CHROME BATH PLUMBING/HARDWARE PACKAGE
- CARPET LEVEL 1
- 6# CARPET PAD
- LAMINATE LEVEL 1 @ENTRY, KITCHEN, NOOK, MUDROOM, POWDER BATH (\*PER PLAN\*)
- FLOORTE @ FULL BATHS/LAUNDRY
- 2 TONE PAINT
- LARGE BASE AND CASE
- KITCHEN CAN PACKAGE
- 80% EFFICIENT FURNACE W/ 13 SEER AC UNIT
- 40 GALLON GAS HOT WATER HEATER
- DRYWALL WRAPPED WINDOW SILLS
- ALL LOW VOLTAGE/TV-DATA TO BE SELECTED WITH THE AUDIO VIDEO COMPANY

\*Fieldstone Homes reserves the right to remove or replace standard options at any time without notice