

CONSTRUCTION NOTES

1. GRADING PLAN LINES, GRADES AND ELEVATIONS ARE SHOWN FOR REFERENCE ONLY. PLEASE SEE CONSTRUCTION SET GRADING PLAN FOR SITE INFORMATION.
2. THE GENERAL CONTRACTOR SHALL COORDINATE THE INSTALLATION OF ALL SUBTERRANEAN CONSTRUCTION WITHIN THE REINFORCED ZONE. M3CE, INC. SHALL BE CONSULTED PRIOR TO ANY EXCAVATION WITHIN THE REINFORCED ZONE. ALL EFFORTS SHALL BE MADE TO COORDINATE INSTALLATION OF SUBTERRANEAN FEATURES DURING WALL CONSTRUCTION.
3. DURING CONSTRUCTION AND AFTER WALL COMPLETION THE FINISHED GRADE SHALL BE GRADED TO DRAIN AWAY FROM THE RETAINING WALL UNTIL FINAL DRAINAGE SYSTEM IS COMPLETE. NO STANDING WATER SHALL BE ALLOWED TO POND ABOVE THE RETAINING WALL.

ANCHOR RETAINING WALL PLAN VIEW

SCALE: 1" = 20'



CITY REVIEW		
DEPARTMENT	SIGN-OFF	DATE
WASTEWATER MANAGEMENT DIV.	SIGNATURE	ON FILE
WATER SERVICES		
STREETS DIV.		
TRAFFIC DIV.		
FIRE		
LANDSCAPE		
SUBDIVISION ENGINEER		
CITY	USE	ONLY

M3CE
ENGINEERED CIVIL SOLUTIONS
 1295 DISTRIBUTION WAY, SUITE C
 VISTA, CA 92081
 760-802-1772 MATT@M3CE.COM

ZOCALO - PHASE 5
 SANTA FE, NEW MEXICO
 INFRASTRUCTURE IMPROVEMENT PLANS
 FOR POD A

ANCHOR WALL PLAN VIEW

DATE: NOVEMBER 2015	SCALE: AS SHOWN	SHEET: 12-2
------------------------	--------------------	----------------

REVISIONS	DATE	ENGINEERS SEAL

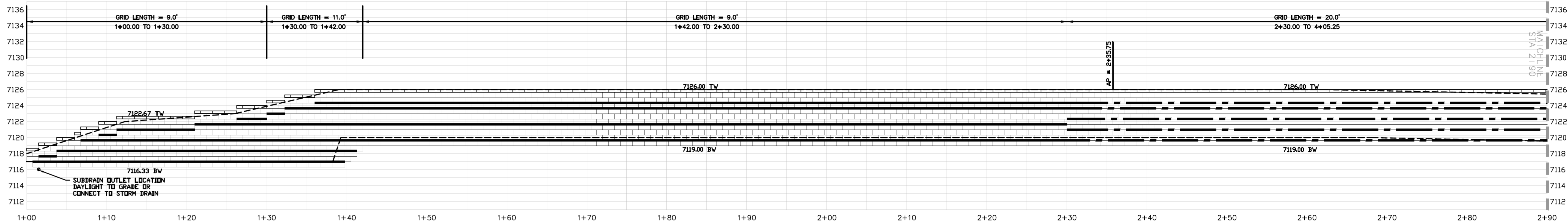

POD B RETAINING WALL 1 PROFILE
STA 1+00 TO 2+90 SCALE: 1" = 6' H/V

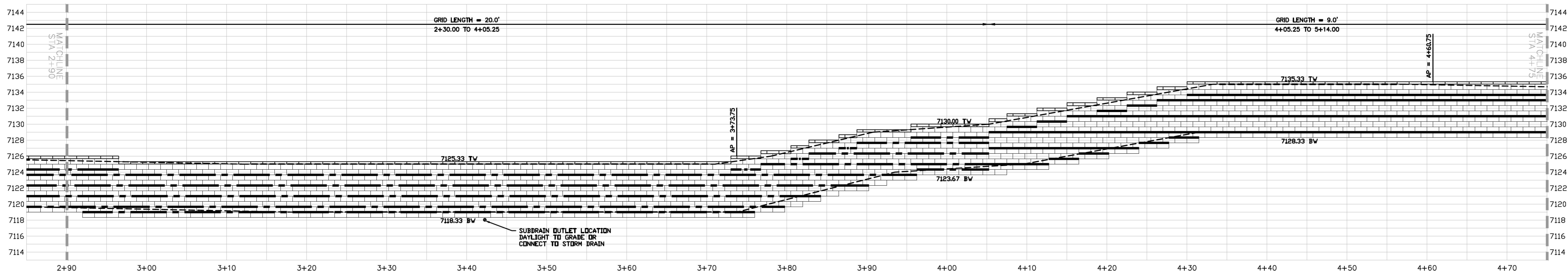

POD B RETAINING WALL 1 PROFILE
STA 2+90 TO 4+75 SCALE: 1" = 6' H/V

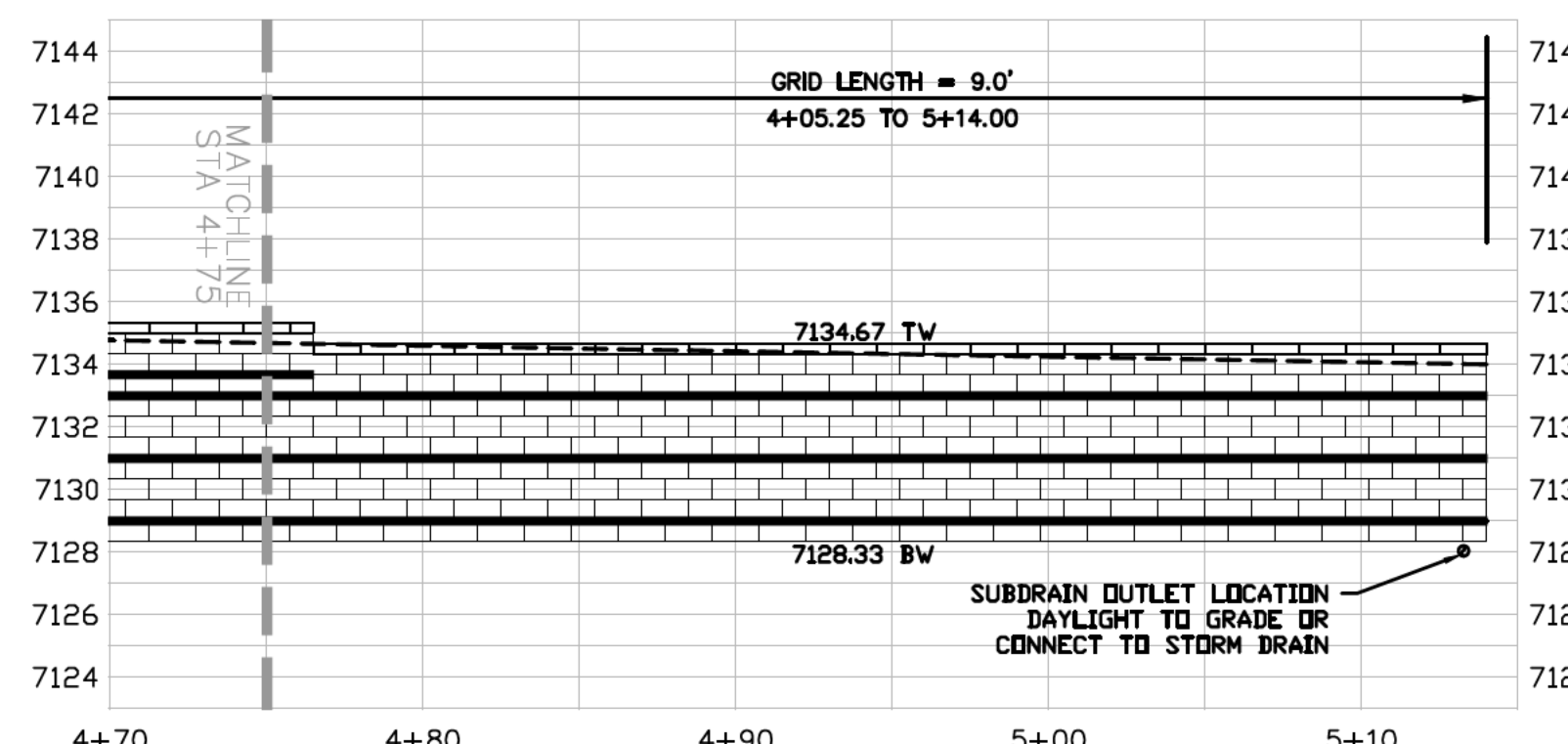

POD B RETAINING WALL 1 PROFILE
STA 4+75 TO 5+14 SCALE: 1" = 6' H/V

LEGEND

- 4" CAP UNIT
- DIAMOND PRO UNIT
- SYNTEEN SF 35
- SYNTEEN SF 55
- SYNTEEN SF 85
- FINISH GRADE
- TOP OF WALL
- BOTTOM OF WALL
- GRID LENGTH
- POINT OF CURVE
- POINT OF TANGENT
- ANGLE POINT
- GRID CHANGE

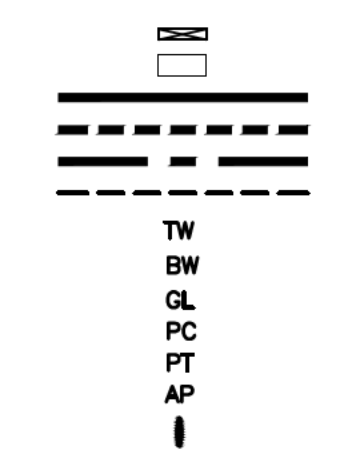

REVISIONS	DATE	ENGINEERS SEAL



CITY REVIEW		
DEPARTMENT	SIGN-OFF	DATE
WASTEWATER MANAGEMENT DIV.	SIGNATURE	ON FILE
WATER SERVICES		
STREETS DIV.		
TRAFFIC DIV.		
FIRE		
LANDSCAPE		
SUBDIVISION ENGINEER		
CITY	USE	ONLY

M3CE
ENGINEERED CIVIL SOLUTIONS
 1295 DISTRIBUTION WAY, SUITE C
 VISTA, CA 92081
 760-802-1772 MATT@M3CE.COM

ZOCALO - PHASE 5
 SANTA FE, NEW MEXICO
 INFRASTRUCTURE IMPROVEMENT PLANS
 FOR POD A

ANCHOR WALL PROFILE

DATE: NOVEMBER 2015 SCALE: AS SHOWN SHEET: 12-3

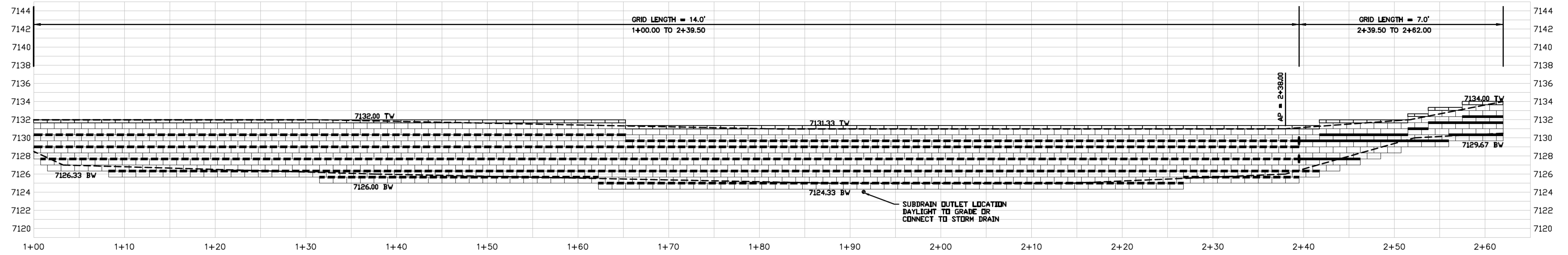

POD B RETAINING WALL 2 PROFILE
SCALE: 1" = 6' H/V

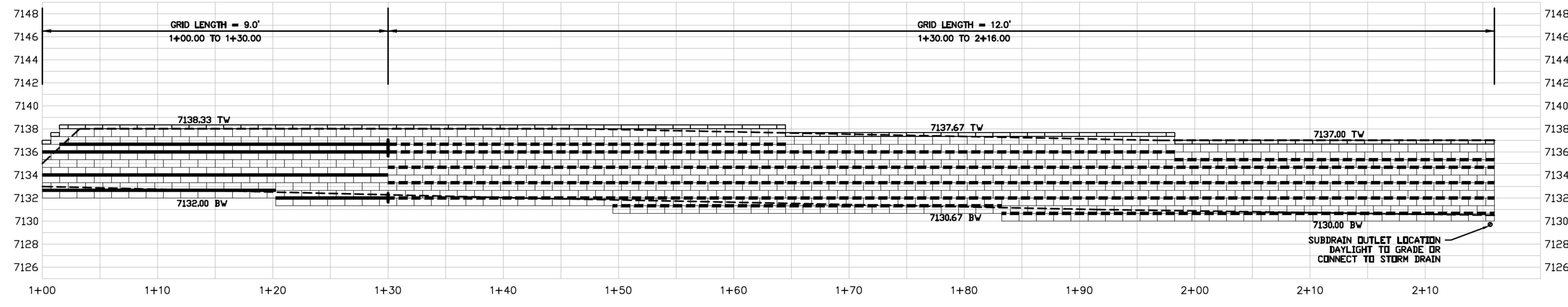

POD B RETAINING WALL 3 PROFILE
SCALE: 1" = 6' H/V

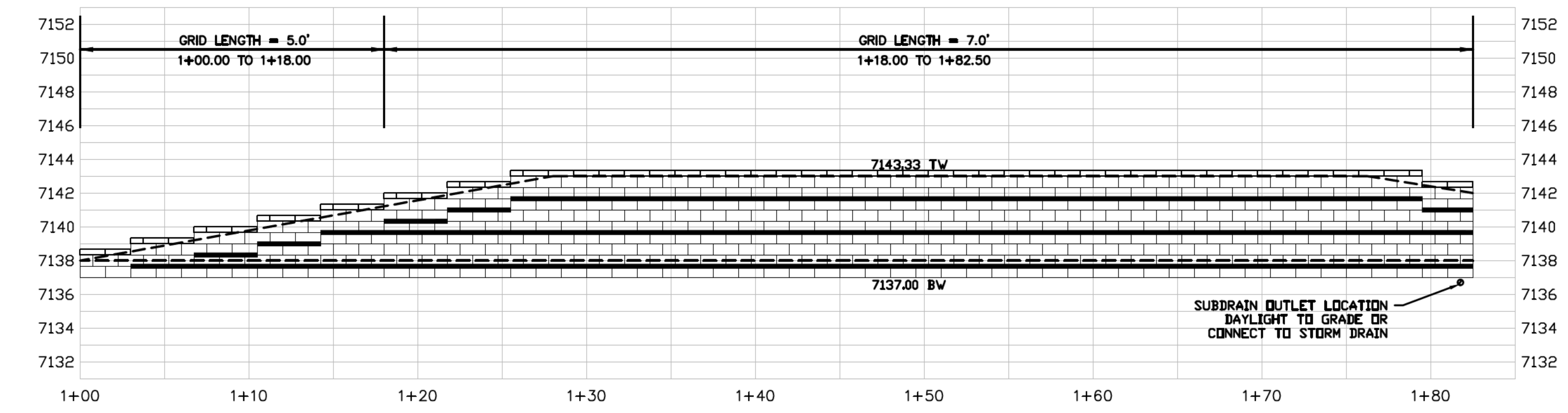

POD B RETAINING WALL 4 PROFILE
SCALE: 1" = 6' H/V

LEGEND
 4" CAP UNIT
 DIAMOND PRO UNIT
 SYNTEN SF 35
 SYNTEN SF 55
 SYNTEN SF 85
 FINISH GRADE
 TOP OF WALL
 BOTTOM OF WALL
 GRID LENGTH
 POINT OF CURVE
 POINT OF TANGENT
 ANGLE POINT
 GRID CHANGE

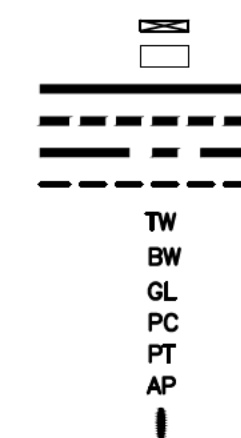

REVISIONS	ENGINEERS SEAL
	DATE



CITY REVIEW		
DEPARTMENT	SIGN-OFF	DATE
WASTEWATER MANAGEMENT DIV.	SIGNATURE ON FILE	
WATER SERVICES		
STREETS DIV.		
TRAFFIC DIV.		
FIRE		
LANDSCAPE		
SUBDIVISION ENGINEER		
CITY	USE	ONLY

M3CE
 ENGINEERED CIVIL SOLUTIONS
 1295 DISTRIBUTION WAY, SUITE C
 VISTA, CA 92081
 760-802-1772 MATT@M3CE.COM

ZOCALO - PHASE 5
 SANTA FE, NEW MEXICO
 INFRASTRUCTURE IMPROVEMENT PLANS
 FOR POD A

ANCHOR WALL PROFILE

DATE: NOVEMBER 2015 SCALE: AS SHOWN SHEET: 12-4

STEP 1 - PLACE REINFORCEMENT SO THAT LITTLE OR NO OVERLAP OCCURS IN THE RADIUS AREA. IF OVERLAP OCCURS, PLACE 2 TO 3 INCHES OF SAND BETWEEN THE REINFORCEMENT LAYERS

2 TO 3 INCHES OF SOIL FILL REQUIRED BETWEEN OVERLAPPED REINFORCEMENT FOR PROPER SOIL AND REINFORCEMENT INTERACTION

STEP 2 - LAY THE NEXT COURSE OF BLOCK. MAKE A MARK ON THE BACK OF THE BLOCKS IN THE AREAS THAT ARE NOT REINFORCED. BACKFILL AND COMPACT THAT COURSE

STEP 3 - PLACE REINFORCEMENT IN THE AREAS WHERE THE MARKS SHOW GAPS IN THE LOWER REINFORCEMENT PATTERN. CONTINUE NORMAL WALL CONSTRUCTION, REPEATING THESE STEPS AS NEEDED

CORES NOT SHOWN FOR CLARITY

PLACE ADDITIONAL REINFORCEMENT ON THE NEXT COURSE OF SEGMENTAL UNITS IMMEDIATELY ABOVE THE SPECIFIED PLACEMENT ELEVATION IN A MANNER THAT ELIMINATES GAPS LEFT BY THE PREVIOUS LAYER OF GEOSYNTHETIC AT THE SPECIFIED REINFORCEMENT ELEVATION

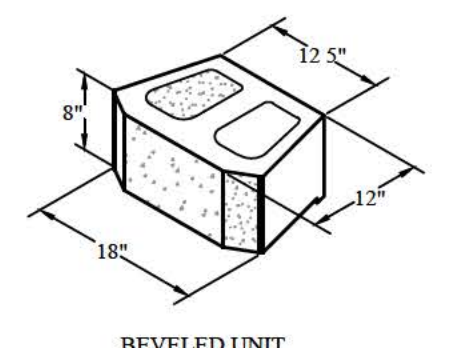

BEVELED UNIT

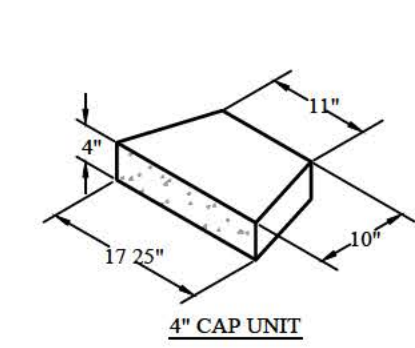

4" CAP UNIT

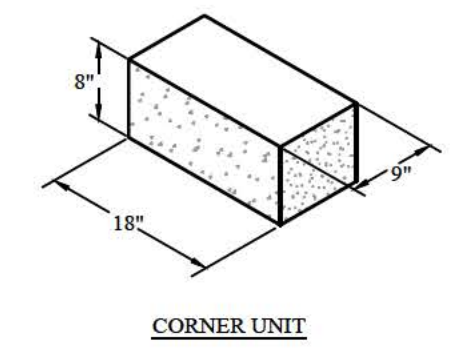

CORNER UNIT

Anchor™ Diamond Pro® ISOMETRIC BLOCK DETAILS
13 NOT TO SCALE

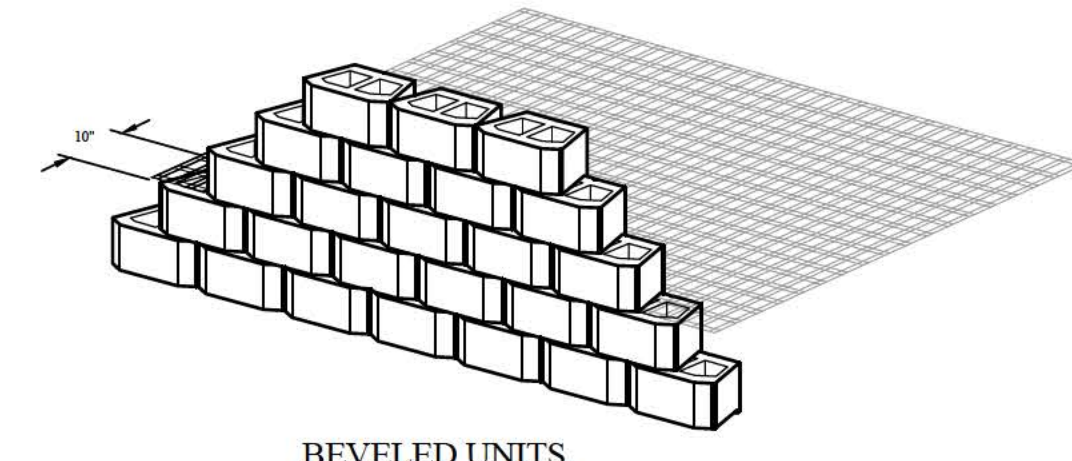

Anchor™ Diamond Pro® REINFORCEMENT CONNECTION DETAIL
13 NOT TO SCALE

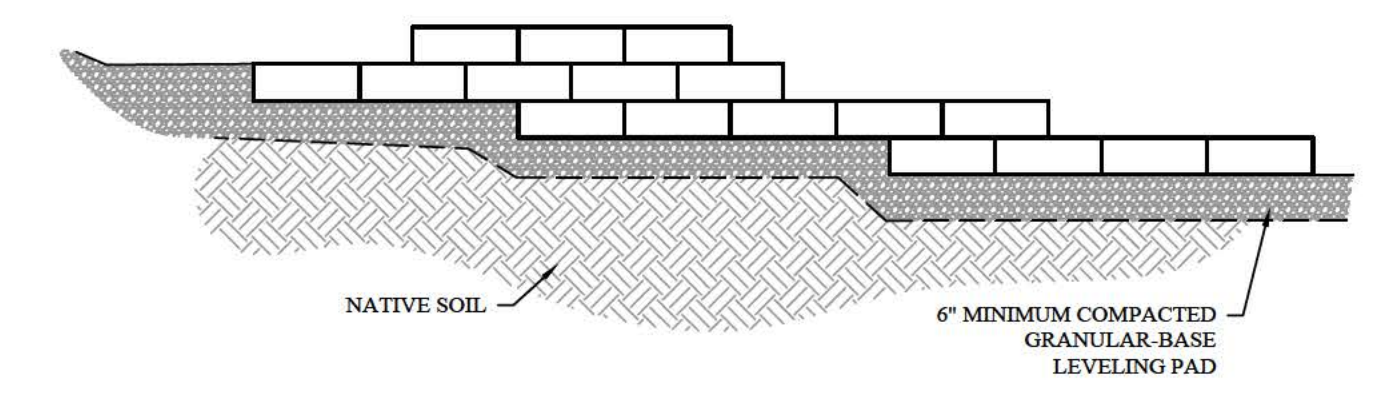

Anchor™ Diamond Pro® TYPICAL STEP-UP DETAIL
13 NOT TO SCALE

Anchor™ Diamond Pro® OUTSIDE CURVE DETAILS
13 NOT TO SCALE

Anchor™ Diamond Pro® INSIDE CURVE DETAILS
13 NOT TO SCALE

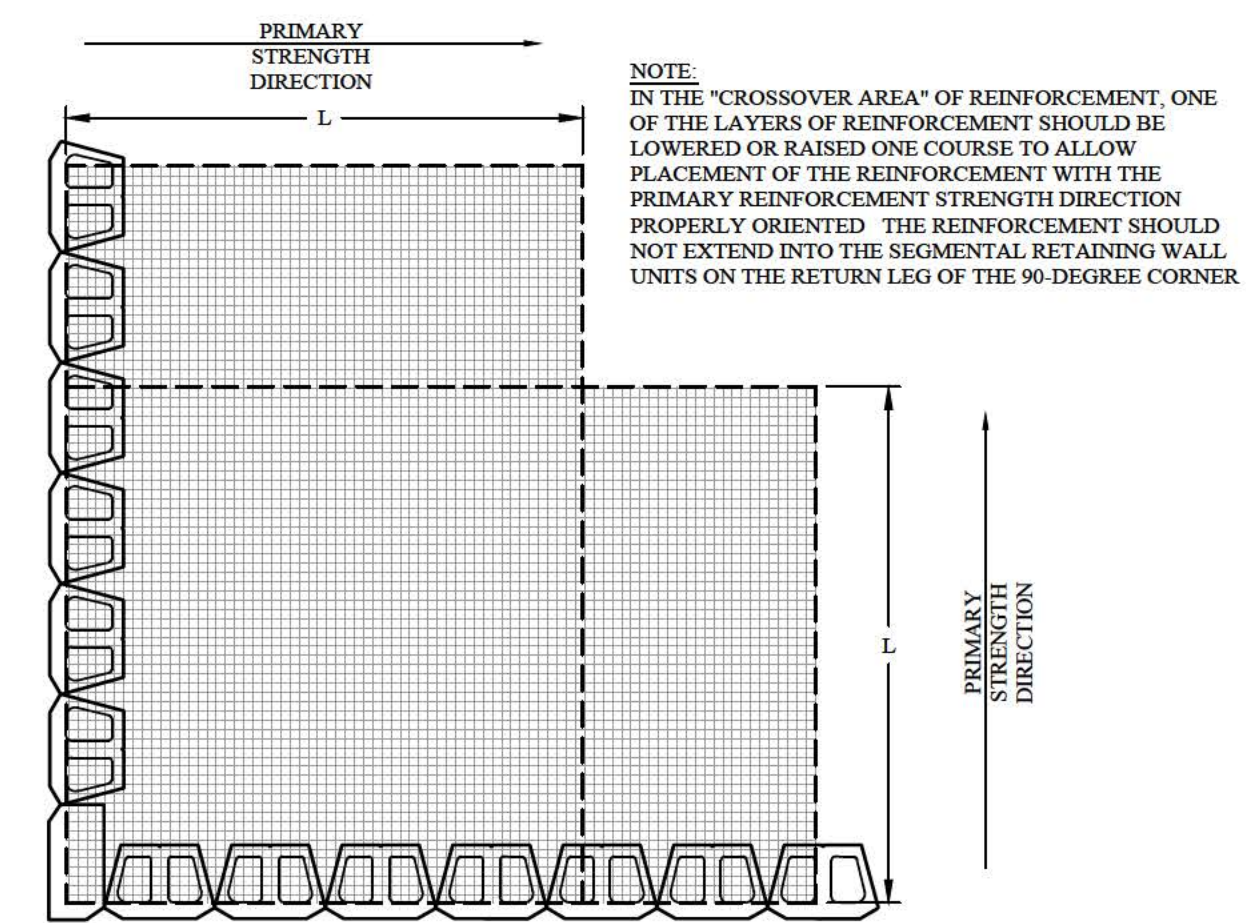

Anchor™ Diamond Pro® 90-DEGREE OUTSIDE CORNER DETAIL
13 NOT TO SCALE

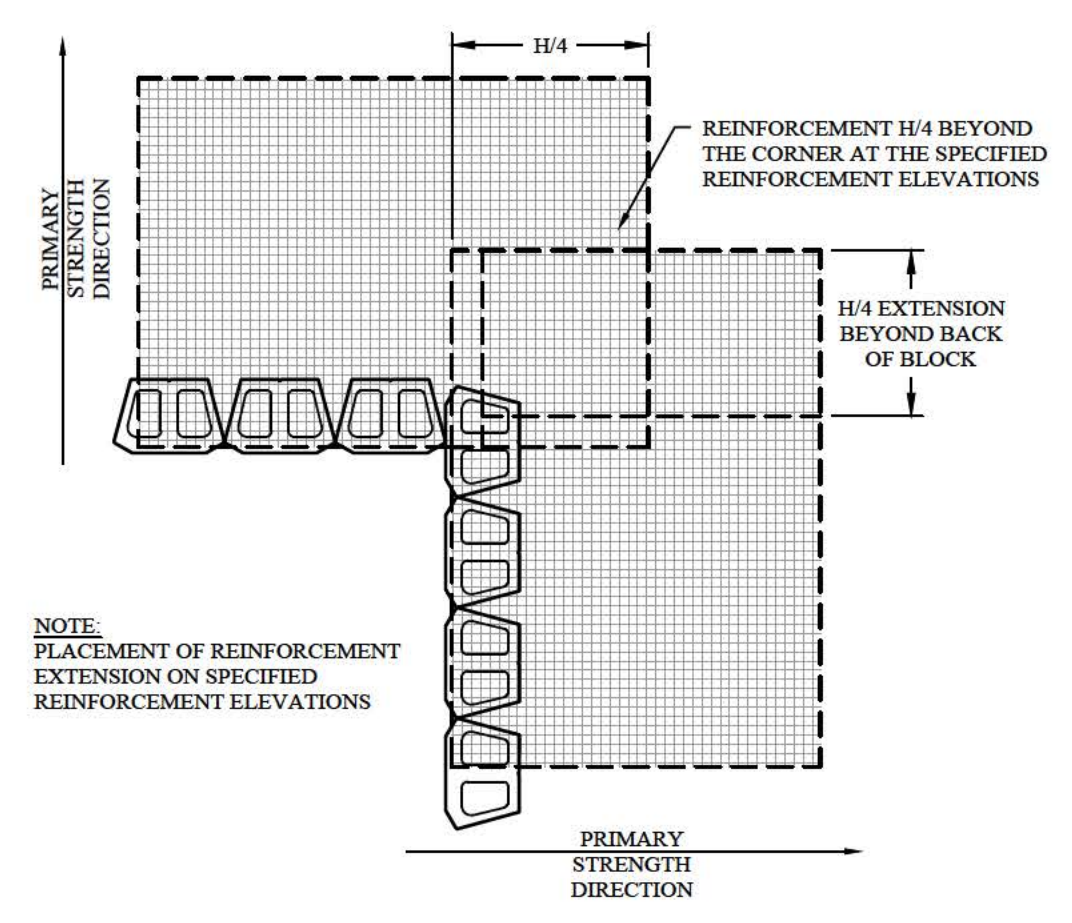

Anchor™ Diamond Pro® 90-DEGREE INSIDE CORNER DETAIL
13 NOT TO SCALE

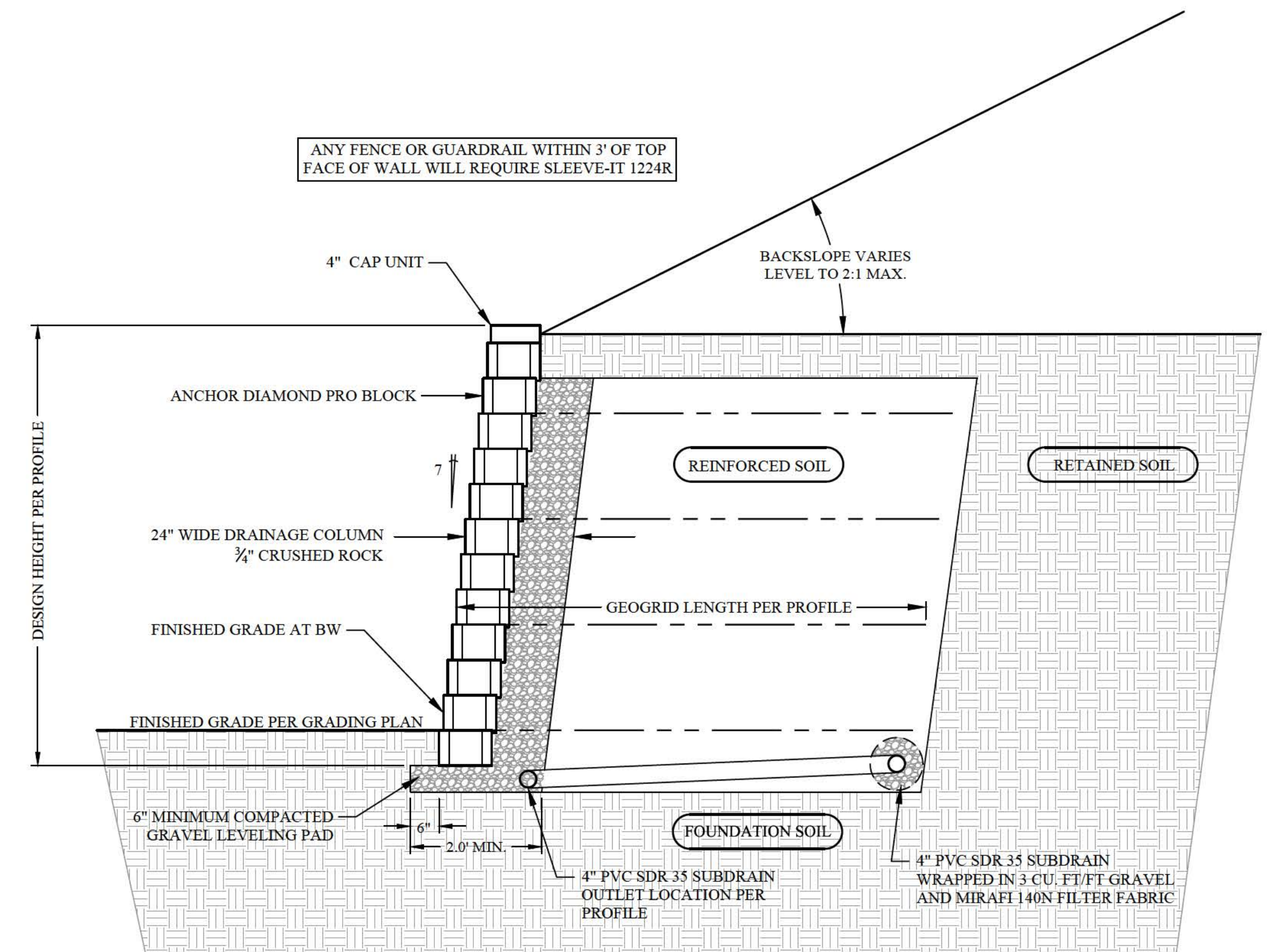

Anchor™ Diamond Pro® TYPICAL DIAMOND PRO WALL SECTION
13 NOT TO SCALE

ENGINEERS SEAL	
DATE	
REVISIONS	

CITY REVIEW		
DEPARTMENT	SIGN-OFF	DATE
WASTEWATER MANAGEMENT DIV.	SIGNATURE	ON FILE
WATER SERVICES		
STREETS DIV.		
TRAFFIC DIV.		
FIRE		
LANDSCAPE		
SUBDIVISION ENGINEER		
CITY	USE	ONLY



M3CE
ENGINEERED CIVIL SOLUTIONS
1295 DISTRIBUTION WAY, SUITE C
VISTA, CA 92081
760-802-1772 MATT@M3CE.COM

ZOCALO - PHASE 5
SANTA FE, NEW MEXICO
INFRASTRUCTURE IMPROVEMENT PLANS
FOR POD A

TYPICAL WALL SECTION AND DETAILS

DATE: NOVEMBER 2015 SCALE: AS SHOWN SHEET: 12-5

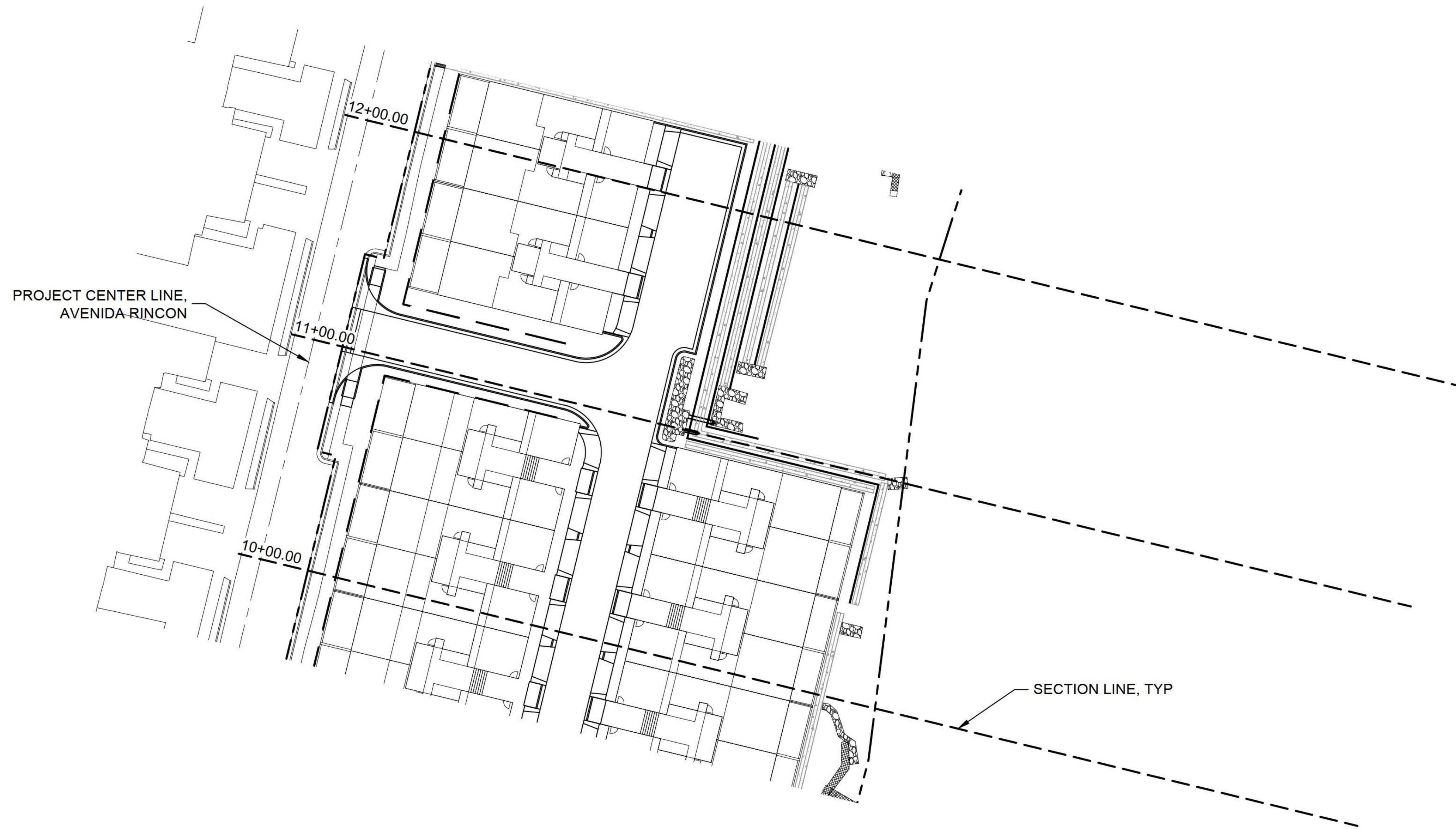

PROJECT CENTER LINE,
AVENIDA RINCON

12+00.00

11+00.00

10+00.00

SECTION LINE, TYP

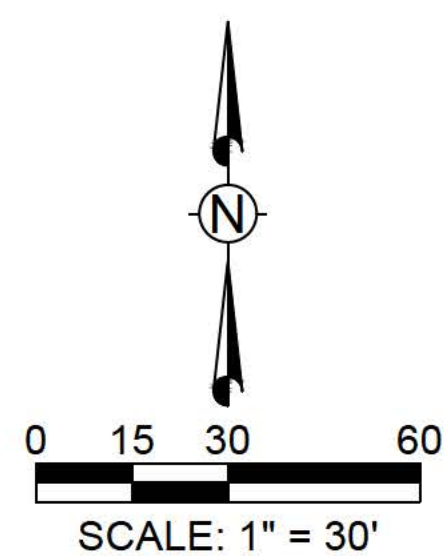

SITE CROSS SECTION LOCATION PLAN
SCALE: 1" = 30'

CITY REVIEW		
DEPARTMENT	SIGN-OFF	DATE
WASTEWATER MANAGEMENT DIV.	SIGNATURE ON FILE	
WATER SERVICES		
STREETS DIV.		
TRAFFIC DIV.		
FIRE		
LANDSCAPE		
SUBDIVISION ENGINEER		
CITY	USE	ONLY



Santa Fe Engineering Consultants, LLC

1599 St. Francis Drive, Suite B
Santa Fe, N. M. 87505
(505) 982-2845 Fax (505) 982-2641
<http://www.SFENGR.com>

ZOCALO - PHASE 5
SANTA FE, NEW MEXICO
INFRASTRUCTURE IMPROVEMENT PLANS
FOR POD B

SITE CROSS SECTION LOCATION PLAN

DATE: MAY 2020 SCALE: 1" = 30' SHEET: 13-1

ENGINEERS SEAL					
DATE					
REVISIONS					

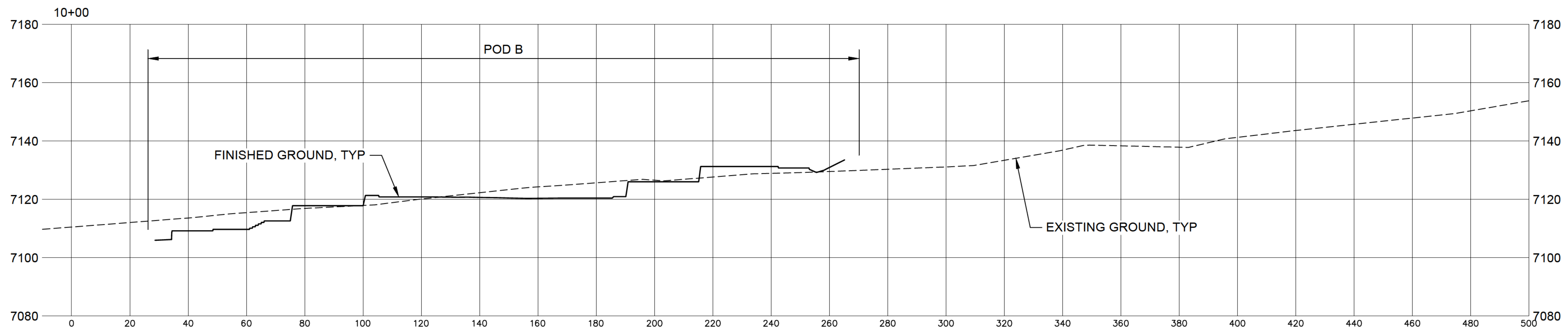
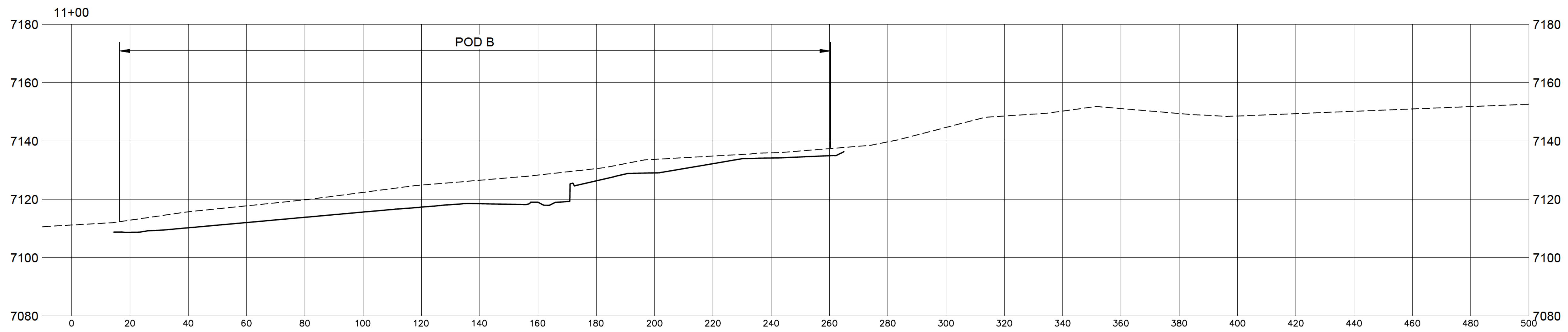
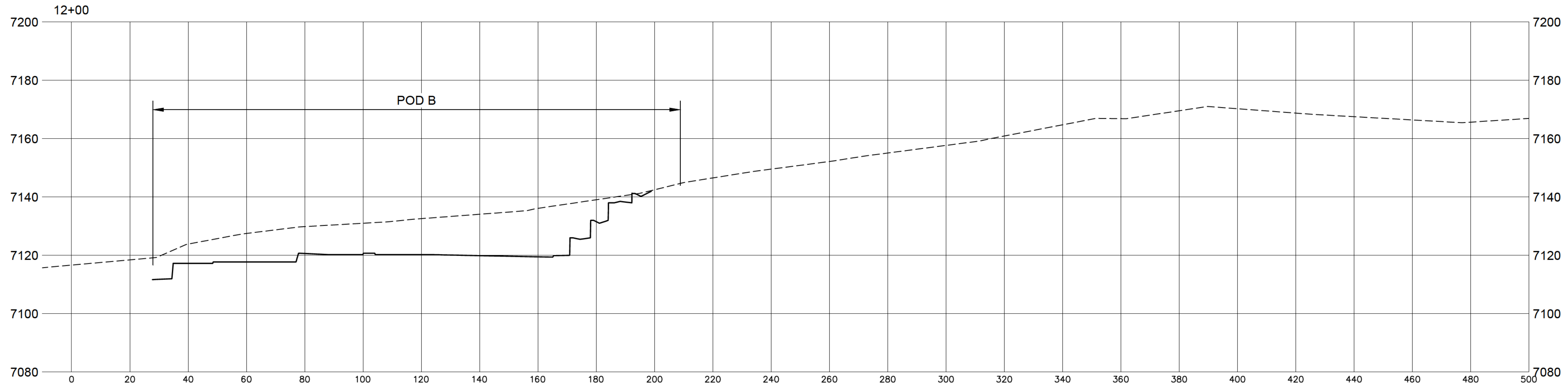

SITE CROSS SECTIONS
 SCALE HORIZ: 1" = 20'
 SCALE VERT: 1" = 20'

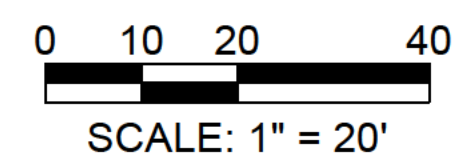

CITY REVIEW		
DEPARTMENT	SIGN-OFF	DATE
WASTEWATER MANAGEMENT DIV.	SIGNATURE	ON FILE
WATER SERVICES		
STREETS DIV.		
TRAFFIC DIV.		
FIRE		
LANDSCAPE		
SUBDIVISION ENGINEER		
CITY	USE	ONLY

SFE C Santa Fe Engineering Consultants, LLC
 1599 St. Francis Drive, Suite B
 Santa Fe, N. M. 87505
 (505) 982-2845 Fax (505) 982-2641
<http://www.SFENGR.com>

ZOCALO - PHASE 5
 SANTA FE, NEW MEXICO
 INFRASTRUCTURE IMPROVEMENT PLANS
 FOR POD B

SITE CROSS SECTIONS		
DATE: MAY 2020	SCALE: 1" = 20'	SHEET: 13-2

ENGINEERS SEAL	
DATE	
REVISIONS	

STORM WATER POLLUTION PREVENTION PLAN
 ZOCALO - PHASE 5, POD B
 SANTA FE, NEW MEXICO

1. SITE AND PROJECT DESCRIPTION

Grading and drainage improvements, construction of roadways, utilities, building pads, retaining walls and miscellaneous improvements. All work is to occur outside the mapped flood plains.

1.1 Owner Operator:

Titan Development
 6300 Riverside Plaza Lane, NW
 Suite 200
 Albuquerque, NM 87120
 505-988-0163

Construction Operator (Separate NPDES Permit needed).

Telephone: _____

Fax: _____

1.2 Location of the site:

The site is located in Township 17 North, Range 9 East, Section 12 & 13, in Santa Fe, New Mexico.

The latitude and longitude are as follows:

Latitude: 35°42'34" N
 Longitude: -105°56'41" W

1.3 The total area of the site:

2.2657 ± acres

1.4 The area of the site that is expected to be disturbed:

1.5175 ± acres

1.5 Endangered Species:

Based on the instruction provided by the EPA Compliance Assurance and Enforcement Division Water Enforcement Branch, Region 6 "Storm Water Region 6 NPDES General Permit for Storm Water Discharge from Construction Activity," there are no endangered or threaten species, or designated critical habitat, which are likely to be adversely affected by the construction activity's storm water discharge or storm water discharge related activities.

1.6 Intended sequence of major construction activities:

1. Install Best Management Practices (BMP's). The contractor shall minimize soil disturbance and insure the proper stockpiling of materials.
2. Site Grading. The contractors shall use site-specific controls as shown on the Temporary Erosion Control Plans and Grading and Drainage Plans. Soil disturbance shall be minimized.
3. Installation of Utilities including trenching, stockpiling of excavated materials and backfilling. The contractors shall use site-specific controls as shown on the Temporary Erosion Control Plans.
4. Stabilization. The contractors shall use site-specific controls as shown on the Permanent Erosion Control Plans.

1.7 The following maps have been prepared:

1.7.1 Vicinity Map

See sheet 1-1.

1.7.2 Drainage patterns:

Grading and Drainage Plans, Sheet Series 8.

1.7.3 Approximate slopes after major grading.

Permanent Erosion Control Plan, sheet 14-3.

1.7.4 Outline area of disturbance:

Permanent Erosion Control Plan, sheet 14-3.

1.7.5 Outline of areas which won't be disturbed:

See SWPPP Plan, sheet 14-1.

1.7.6 Location of major structural and non-structural concepts:

Temporary Erosion Control Plan, sheet 14-2.

1.7.7 Areas where stabilization practices are expected to occur.

Permanent Erosion Control Plan, sheet 14-3.

2. DESCRIPTION OF CONTROLS

2.1 Posting Requirements:

The Contractor will post conspicuously near the entrance to the site the following items:

Copies of NOIs
 Name and telephone number of contact persons.

2.2 "Good Housekeeping":

The contractors shall practice "Good Housekeeping." This includes the proper disposal of construction and demolition debris on a daily basis, proper wash down methods of construction vehicles, the proper stockpiling of materials. The construction site shall be kept in a neat and orderly manner and exposure of material to storm water will be minimized to the extent practicable.

2.3 Concrete Washout

Concrete washout is a process wastewater and must be controlled in a designated area (e.g. bermed pit) and disposed of properly and noted on the Temporary Erosion Control Plans.

2.4 Minimize Disturbance and Preserve Natural Vegetation:

The Contractor shall minimize disturbance. The limits of construction shall be clearly delineated and enforced. Special attention will be given to protecting established vegetation. The contractor will be responsible for replacing vegetation that is unnecessarily disturbed.

2.5 Inspections:

Disturbed areas, stabilization and structural control measures shall be inspected as required and at least once every two weeks, and within 24 hours or the next working day of the end of a storm event. If a portion of the site has been finally or temporarily stabilized, and runoff is unlikely due to winter conditions, or during seasonal arid periods, inspections shall be conducted on a monthly basis.

Inspections shall be documented on the inspection and maintenance form. Inspections shall be continued by the Owner and final stabilization of an area is achieved and/or the Notice of Termination is submitted.

2.6 Record Keeping:

A copy of the SWPP Plan will be maintained onsite for the use of all Operators and those identified in the SWPP Plan as having on site responsibilities. Items that will be maintained and attached to the SWPPP include:

Inspection Reports: The inspection reports shall be signed by a qualified inspector assigned by the Contractor. The SWPPP package and reports shall be available to EPA representatives at all times during construction.

Land Disturbance Log containing: dates when major soil disturbing activities occur, dates when construction activities temporarily or permanently cease on a portion of the site, and dates when stabilization measures are initiated.

Spill Tracking

Copies of SWPP Plans, inspection records, spill reports, all reports required by NPDES Permit coverage, and data used to complete the NOI shall be retained by the permittees.

2.7 Plan Amendment:

This SWPP Plan will be amended when:

There is a change in design, construction, operation, or maintenance.

If the inspection report identifies problems or inadequacies with the current BMPs, the SWPP Plan shall be modified as necessary to include additional or modified BMP's designed to correct the problems.

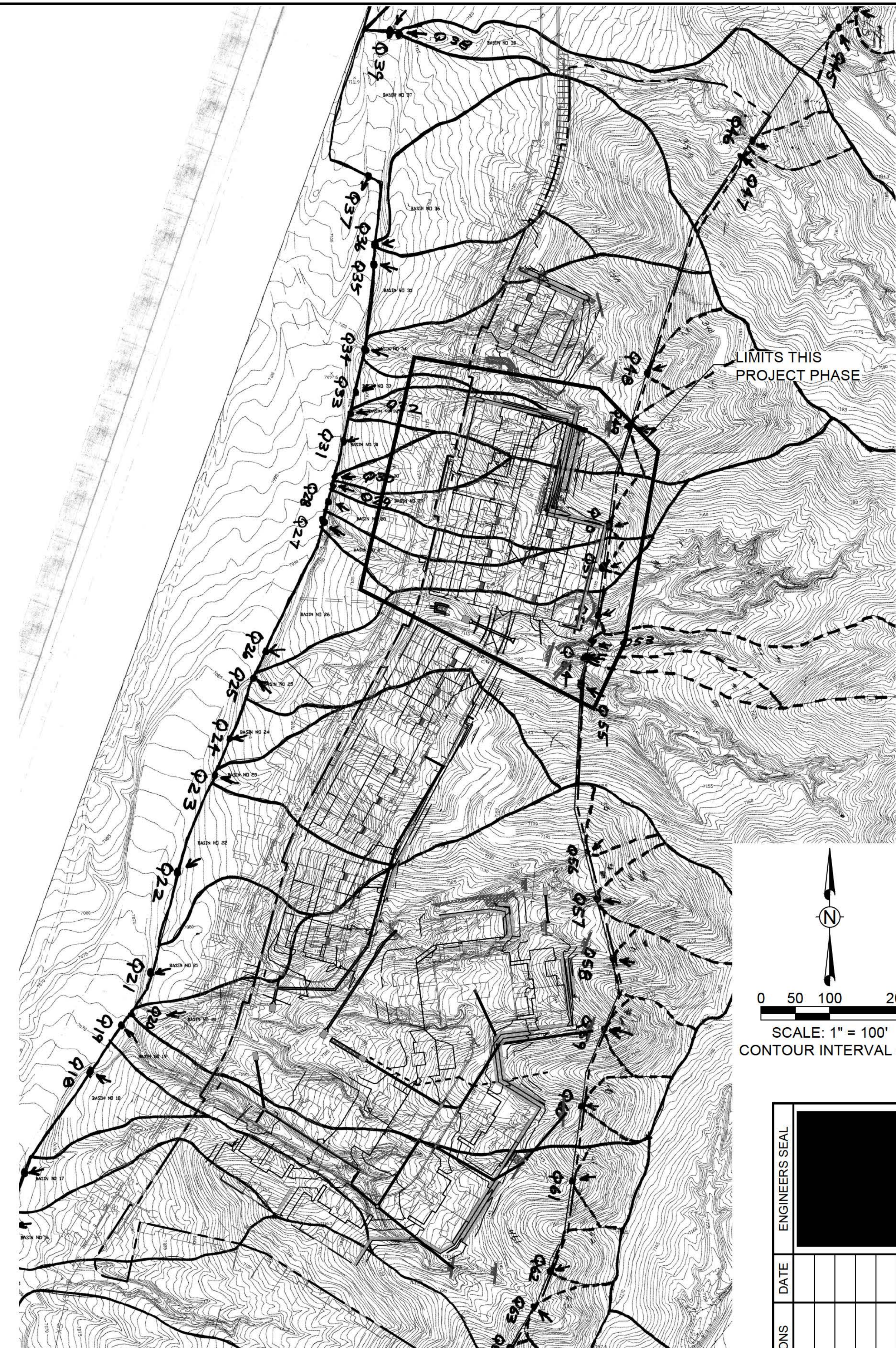

DRAINAGE MAP
 SCALE: 1" = 100'

CITY REVIEW		
DEPARTMENT	SIGN-OFF	DATE
WASTEWATER MANAGEMENT DIV.	SIGNATURE	ON FILE
WATER SERVICES		
STREETS DIV.		
TRAFFIC DIV.		
FIRE		
LANDSCAPE		
SUBDIVISION ENGINEER		
CITY	USE	ONLY

SFE C Santa Fe Engineering Consultants, LLC
 1599 St. Francis Drive, Suite B
 Santa Fe, N. M. 87505
 (505) 982-2645 Fax (505) 982-2641
 http://www.SFENGR.com

ZOCALO - PHASE 5
 SANTA FE, NEW MEXICO
 INFRASTRUCTURE IMPROVEMENT PLANS
 FOR POD B

STORM WATER POLLUTION PREVENTION PLAN

DATE: MAY 2020 SCALE: 1" = 100' SHEET: 14-1

ENGINEER'S SEAL	[Redacted Seal]			
	DATE			
REVISIONS				

BEST MANAGEMENT PRACTICES - NOTES

1. DISTURBED AREAS SHALL BE PROTECTED FROM EROSION DURING CONSTRUCTION BY MEANS ADEQUATE TO RETAIN SOIL ON SITE.
2. EXCEPT AS NECESSARY TO INSTALL TEMPORARY EROSION AND SEDIMENT CONTROL DEVICES, LAND SHALL NOT BE GRADED OR CLEARED UNTIL ALL SUCH TEMPORARY DEVICES HAVE BEEN PROPERLY INSTALLED AND INSPECTED. CONTROL DEVICES SHALL BE KEPT IN PLACE AND USED UNTIL THE DISTURBED AREA IS PERMANENTLY STABILIZED.
3. SIGNIFICANT TREES, AREAS WITH SUBSTANTIAL GRASS COVERAGE, AND DRAINAGE WAYS THAT ARE TO REMAIN UNDISTURBED SHALL BE FENCED OFF PRIOR TO THE USE OF ANY HEAVY MACHINERY ON-SITE AND DURING THE ENTIRE CONSTRUCTION PROCESS. FENCING SHALL BE PLACED FIVE FEET TO THE OUTSIDE OF THE DRIP LINE OF SIGNIFICANT TREES. THERE ARE NO SIGNIFICANT TREES.
4. SOIL STOCKPILES SHALL BE PROTECTED FROM EROSION THROUGHOUT CONSTRUCTION BY USING APPROPRIATE EROSION CONTROL TECHNIQUES. STAGING AND SOIL STOCKPILE AREAS SHALL BE CLEARLY DESIGNED ON THE SITE. ALL TOPSOIL SHALL BE KEPT ON SITE, WITHIN THE DISTURBANCE ZONE OF CONSTRUCTION, AND REINTRODUCED IN TO PLANTING AREAS TO THE EXTENT POSSIBLE. THERE ARE NO SOIL STOCKPILES ASSOCIATED WITH THIS PROJECT.
5. WATERING DOWN EXPOSED AREAS IS REQUIRED TO PREVENT THE BLOWING OF DUST OR SEDIMENT.
6. PROTECTION FOR STORM DRAIN INLETS SHALL BE PROVIDED TO PREVENT THE ENTRY OF SEDIMENT WHILE STILL ALLOWING THE ENTRY OF STORMWATER.
7. EROSION AND SEDIMENT CONTROL SHALL BE ACCOMPLISHED BY WATERING AND/OR FIBER MULCH WITH TACKIFIER
8. ALL CONSTRUCTION TRAFFIC SHALL USE TIRE WASHES.

MAINTENANCE RESPONSIBILITIES AND INSPECTIONS

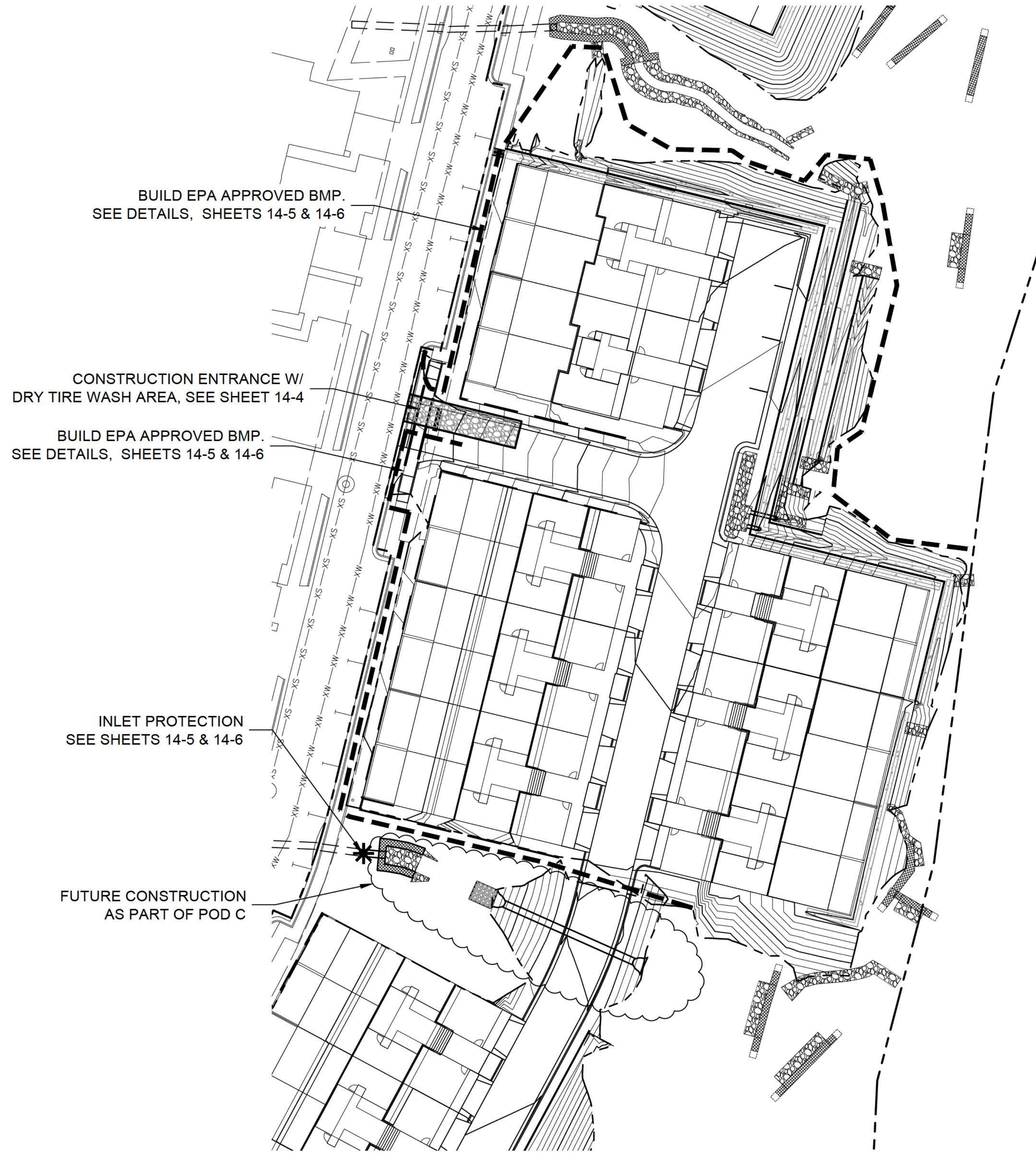

1. DISTURBED AREAS, STABILIZATION AND STRUCTURAL CONTROL MEASURES SHALL BE INSPECTED AS REQUIRED AND AT LEAST ONCE EVERY TWO WEEKS, AND WITHIN 24 HOURS OR THE NEXT WORKING DAY OF THE END OF A STORM EVENT. IF A PORTION OF THE SITE HAS BEEN FINALLY OR TEMPORARILY STABILIZED, AND RUNOFF IS UNLIKELY DUE TO WINTER CONDITIONS, OR DURING SEASONAL ARID PERIODS, INSPECTIONS SHALL BE CONDUCTED ON A MONTHLY BASIS.
2. ALL STORMWATER FACILITIES SHALL BE MAINTAINED BY THE CONTRACTOR.
3. THE STORMWATER MANAGEMENT SYSTEM SHALL BE MAINTAINED IN GOOD CONDITION AND PROMPTLY REPAIRED.
4. THE CITY OR ITS AUTHORIZED AGENT MAY ENTER UPON THE PROPERTY, AT REASONABLE TIME TO ENSURE THAT THE SYSTEM IS MAINTAINED IN PROPER WORKING CONDITION.
5. IF AFTER NOTICE BY THE CITY TO CORRECT A VIOLATION REQUIRING MAINTENANCE WORK, SATISFACTORY CORRECTIONS ARE NOT MADE WITHIN A REASONABLE PERIOD OF TIME, THE CITY MAY PERFORM ALL NECESSARY WORK TO PLACE THE FACILITY IN PROPER WORKING CONDITION. THE OWNER(S) OR RESPONSIBLE PARTY OF THE FACILITY SHALL BE ASSESSED THE ASSOCIATED COSTS OF THE WORK.



TEMPORARY EROSION CONTROL PLAN
SCALE: 1" = 30'

EPA APPROVED BMP. SEE SHEETS 14-5 & 14-6 FOR DETAILS

LEGEND

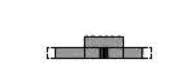
	CONSTRUCTION ENTRANCE W/ DRY TIRE WASH AREA. SEE SHEET 14-4 FOR DETAILS
	EPA APPROVED BMP. SEE SHEETS 14-5 & 14-6 FOR DETAILS
	INLET PROTECTION. SEE SHEETS 14-5 & 14-6 FOR DETAILS
	GABION CHECK DAM SILTATION POND

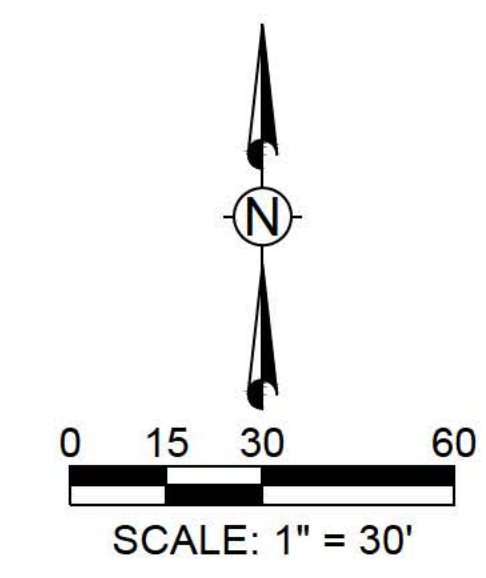

ENGINEERS SEAL				
	DATE			
REVISIONS				

CITY REVIEW		
DEPARTMENT	SIGN-OFF	DATE
WASTEWATER MANAGEMENT DIV.	SIGNATURE	ON FILE
WATER SERVICES		
STREETS DIV.		
TRAFFIC DIV.		
FIRE		
LANDSCAPE		
SUBDIVISION ENGINEER		
CITY	USE	ONLY

SFE C Santa Fe Engineering Consultants, LLC
 1599 St. Francis Drive, Suite B
 Santa Fe, N. M. 87505
 (505) 982-2845 Fax (505) 982-2641
<http://www.SFENGR.com>

ZOCALO - PHASE 5
 SANTA FE, NEW MEXICO
 INFRASTRUCTURE IMPROVEMENT PLANS
 FOR POD B

TEMPORARY EROSION CONTROL PLAN

DATE: MAY 2020	SCALE: 1" = 30'	SHEET: 14-2
-------------------	--------------------	----------------

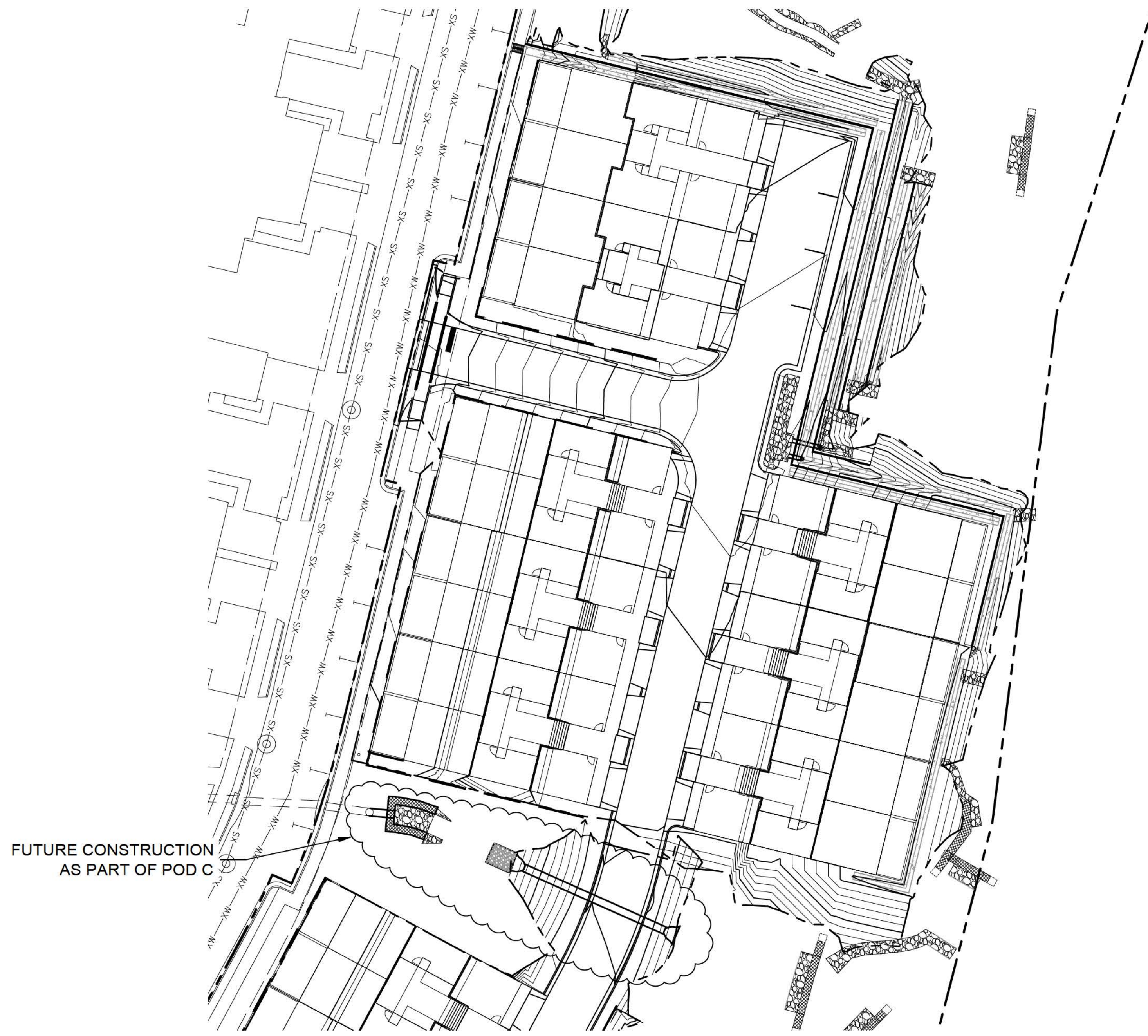

PERMANENT EROSION CONTROL PLAN
SCALE: 1" = 30'

LONG TERM MAINTENANCE RESPONSIBILITIES AND INSPECTIONS

1. ALL STORM WATER FACILITIES SHALL BE MAINTAINED BY THE DEVELOPMENT ASSOCIATION.
2. THE STORM WATER MANAGEMENT SYSTEM SHALL BE MAINTAINED IN GOOD CONDITION AND PROMPTLY REPAIRED.
3. THE CITY OR ITS AUTHORIZED AGENT MAY ENTER UPON THE PROPERTY, AT REASONABLE TIMES TO ENSURE THAT THE SYSTEM IS MAINTAINED IN PROPER WORKING CONDITION.
4. IF AFTER NOTICE BY THE CITY TO CORRECT A VIOLATION REQUIRING MAINTENANCE WORK, SATISFACTORY CORRECTIONS ARE NOT MADE WITHIN A REASONABLE PERIOD OF TIME. THE CITY MAY PERFORM ALL NECESSARY WORK TO PLACE THE FACILITY IN PROPER WORKING CONDITION. THE OWNER(S) OR RESPONSIBLE PARTY OF THE FACILITY SHALL BE ASSESSED THE ASSOCIATED COSTS OF THE WORK.

INSPECTIONS AND VIOLATIONS DURING CONSTRUCTION PROCESS

1. INSPECTIONS BY CITY ARE DUE WHEN STORM WATER MANAGEMENT MEASURES ARE COMPLETED AND WHEN THE FINAL SITE RESTORATION MEASURES ARE COMPLETED. HOWEVER, IF FINAL SITE RESTORATION MEASURES ARE BEING DELAYED DUE TO THE SEASON, THE CITY SHALL BE NOTIFIED WHEN TEMPORARY EROSION CONTROL MEASURES FOR USE UNTIL RESTORATION IS COMPLETE, IN PLACE AND READY FOR INSPECTION.
2. FURTHER CONSTRUCTION OR ISSUANCE OF ANY PERMITS SHALL NOT OCCUR UNTIL WRITTEN APPROVAL HAS BEEN GRANTED BY THE CITY.

STORMWATER FACILITIES MAINTENANCE SCHEDULE

SPRING MAINTENANCE:	MARCH 21st	CLEARING AND MAINTENANCE FOR ALL STORMWATER MANAGEMENT FACILITIES SHALL OCCUR WITHIN 30 DAYS OF DATE. REMOVE SEDIMENT BUILD UP IN ALL PONDS AND RESEED.
FALL MAINTENANCE:	SEPTEMBER 18th	CLEARING AND MAINTENANCE FOR ALL STORMWATER MANAGEMENT FACILITIES SHALL OCCUR WITHIN 30 DAYS OF DATE.
PERIODIC MAINTENANCE:	AFTER SIGNIFICANT STORMS	CLEARING AND MAINTENANCE FOR ALL STORMWATER MANAGEMENT FACILITIES SHALL OCCUR WITHIN 30 DAYS OF STORM.

SFCC 13-2 PROHIBITS THE DISCHARGE OF POLLUTANTS INCLUDING SEDIMENT, VEGETATION, SLURRIES, MUD, PLASTERS, CONCRETE RESINATES AND ANY CONSTRUCTION MATERIALS, WASTES AND GARBAGE, ETC. TO THE STORM DRAIN SYSTEM. THE STORM DRAIN SYSTEM INCLUDES ROADS, STREETS, CURBS, GUTTERS, DRIP INLETS, PIPED STORM DRAINS, CULVERTS, RETENTION AND DETENTION BASINS, NATURAL AND MAN-MADE DRAINAGE CHANNELS, ARROYOS, RIVERS, AND ANY FACILITY AND APPURTENANCE BY WHICH STORMWATER IS COLLECTED AND/OR CONVEYED. CULVER AND DRAIN FLUSHING SHALL BE CAREFULLY DONE. POLLUTANTS AND DEBRIS SHALL BE CAREFULLY REMOVED AND DISPOSED OF AT THE LANDFILL.

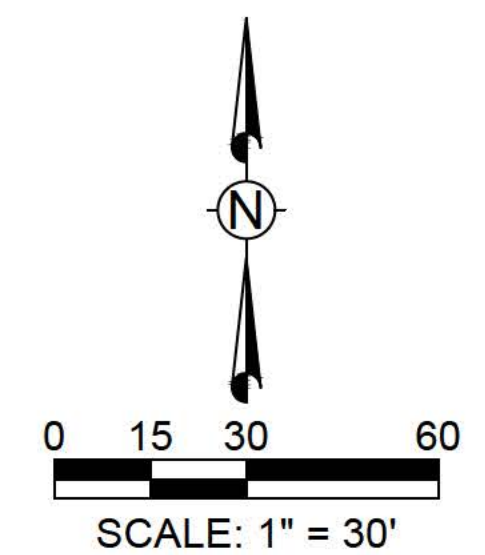

ENGINEER'S SEAL	
DATE	
REVISIONS	

CITY REVIEW		
DEPARTMENT	SIGN-OFF	DATE
WASTEWATER MANAGEMENT DIV.	SIGNATURE ON FILE	
WATER SERVICES		
STREETS DIV.		
TRAFFIC DIV.		
FIRE		
LANDSCAPE		
SUBDIVISION ENGINEER		
CITY	USE	ONLY

S F E C
Santa Fe Engineering Consultants, LLC
 1599 St. Francis Drive, Suite B
 Santa Fe, N. M. 87505
 (505) 982-2845 Fax (505) 982-2641
<http://www.SFENGR.com>

ZOCALO - PHASE 5 SANTA FE, NEW MEXICO INFRASTRUCTURE IMPROVEMENT PLANS FOR POD B		
PERMANENT EROSION CONTROL PLAN		
DATE: MAY 2020	SCALE: 1" = 30'	SHEET: 14-3

NOTES:

1. THE ENTRANCE SHALL BE MAINTAINED IN A CONDITION THAT WILL MINIMIZE SEDIMENT TRACKING OR TRANSPORT ONTO PUBLIC ROADWAYS. THIS MAY REQUIRE ADDING ADDITIONAL LAYERS OF GRAVEL, REPAIR AND/OR CLEANOUT OF MEASURE USED TO TRAP SEDIMENT.
2. WHEN NECESSARY, WHEELS SHALL BE CLEANED PRIOR TO ENTRANCE ONTO PUBLIC ROADWAYS.
3. VEHICLE WASHING SHALL BE CONDUCTED IN A STABILIZED AREA WITH APPROPRIATE STORM WATER CONTROLS IN PLACE.

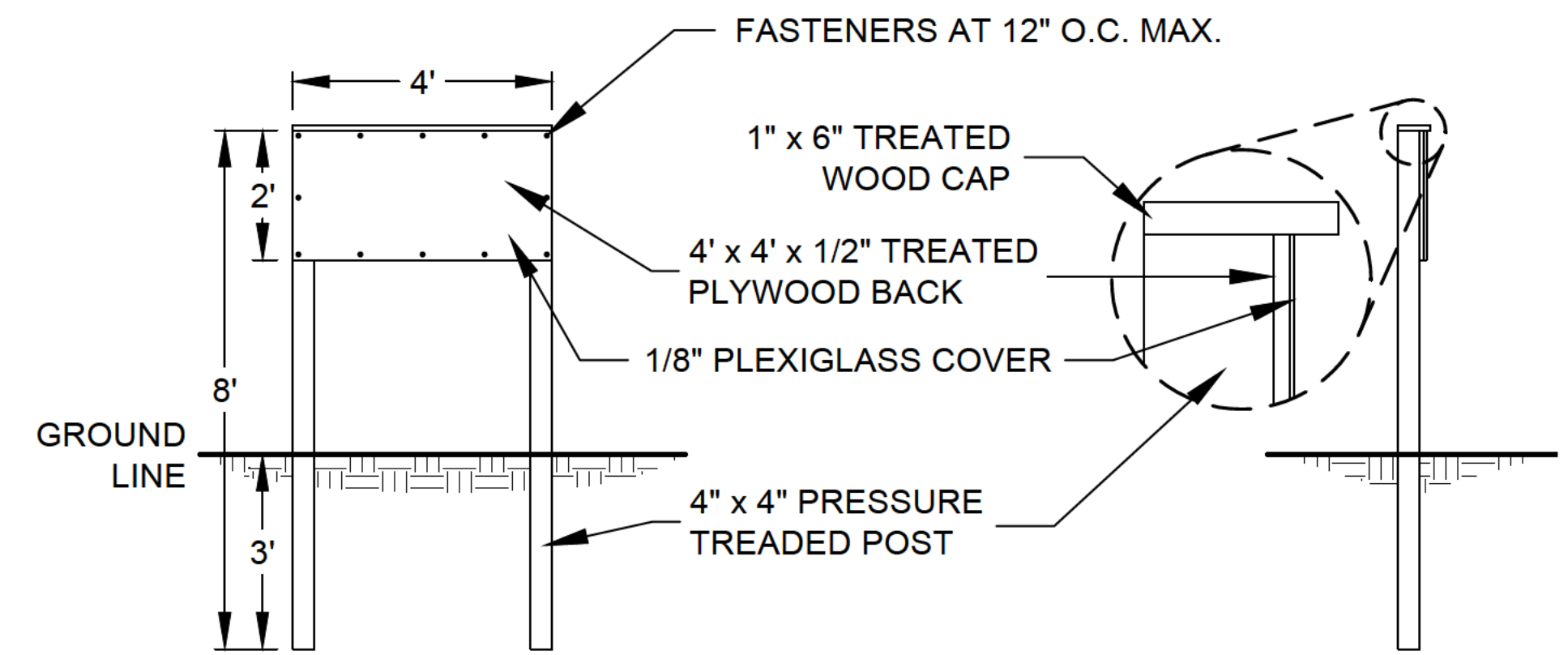
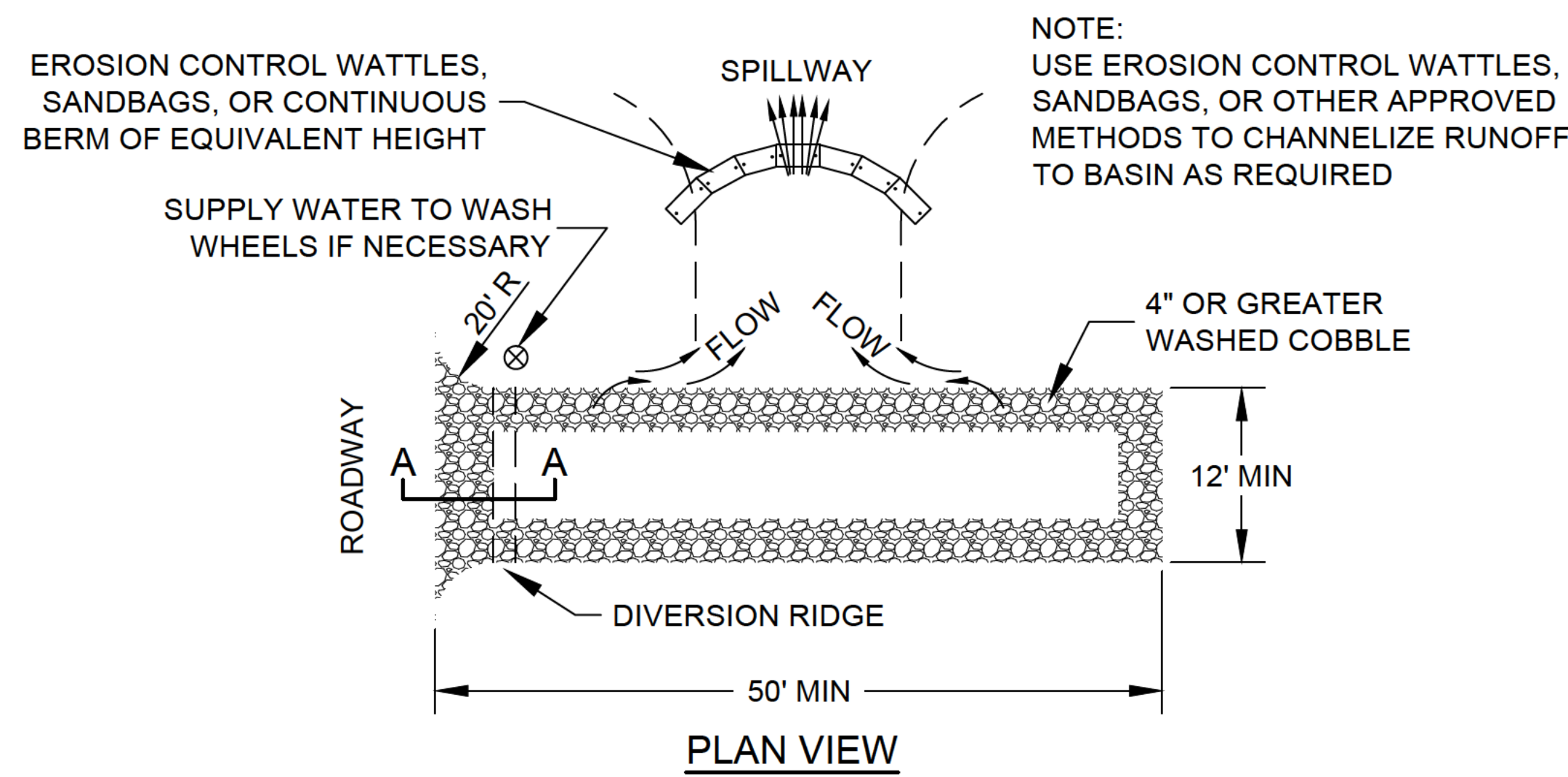
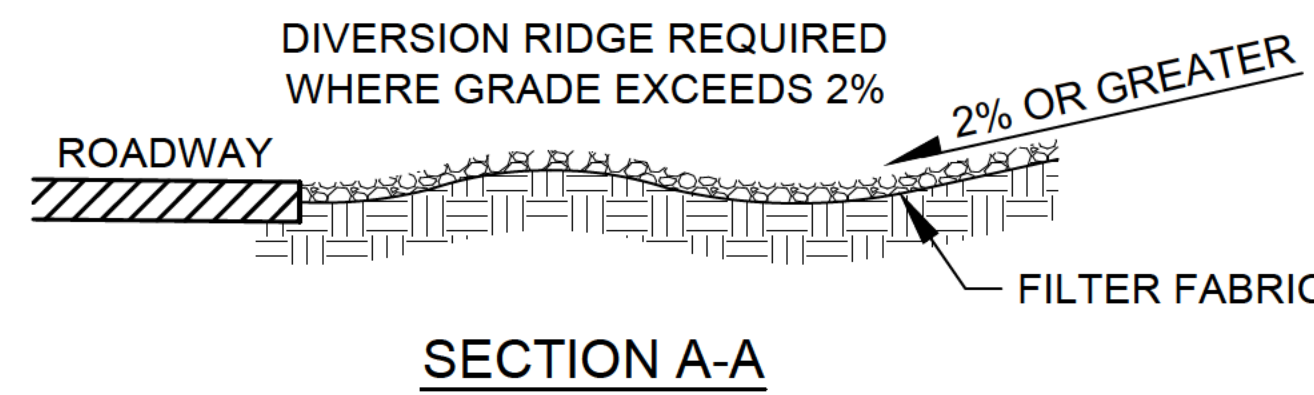

**TEMPORARY GRAVEL CONSTRUCTION
ENTRANCE / EXIT**

CITY OF SANTA FE NPDES STORMWATER MANAGEMENT NOTES

1. DEVELOPMENT IS SUBJECT TO THE REQUIREMENTS OF THE SFCC CHAPTER XIII STORMWATER UTILITY INCLUDING THE STORMWATER UTILITY SERVICE CHARGE AND STORMWATER ILLICIT DISCHARGE CONTROL REQUIREMENTS.
2. DEVELOPMENT IS SUBJECT TO THE REQUIREMENTS OF NPDES GENERAL MS4 DISCHARGE PERMIT NO. NMR040000 AND NPDES CONSTRUCTION GENERAL PERMIT NO. NMR 100000.
3. CONSTRUCTION GENERAL DISCHARGE PERMIT NO. NMR100000- A STORMWATER POLLUTION PREVENTION PLAN MUST BE PREPARED BY A QUALIFIED PROFESSIONAL AND A NOTICE OF INTENT (NOI) FOR COVERAGE MUST BE FILED WITH THE EPA. CONSTRUCTION STORMWATER DISCHARGES ARE NOT PERMITTED UNTIL A MINIMUM OF SEVEN (7) CALENDAR DAYS AFTER EPA ACKNOWLEDGEMENT OF A COMPLETE NOI.
4. CITY OF SANTA FE STORMWATER ILLICIT DISCHARGE CONTROL- SFCC 13-2 PROHIBITS THE DISCHARGE OF POLLUTANTS INCLUDING SEDIMENT, SLURRIES, MUD, PLASTERS, CONCRETE RINSATES AND ANY CONSTRUCTION MATERIALS, WASTES AND GARBAGE, ETC. TO THE STORM DRAIN SYSTEM. THE STORM DRAIN SYSTEM INCLUDES ROADS, STREETS, CURBS, GUTTERS, DROP INLETS, PIPED STORM DRAINS, CULVERTS, RETENTION AND DETENTION BASINS, NATURAL AND MAN-MADE DRAINAGE CHANNELS, ARROYOS, RIVERS AND ANY FACILITY AND APPURTENANCE BY WHICH STORMWATER IS COLLECTED AND/OR CONVEYED.
5. CITY OF SANTA FE TERRAIN AND STORMWATER REGULATIONS- SFCC 14-8.2 REQUIRES THAT CONSTRUCTION DISTURBED AREA SHALL BE PROTECTED AGAINST EROSION. SEDIMENT MUST BE CONTAINED ON THE DISTURBED AREA BY THE USE OF TEMPORARY EROSION AND SEDIMENT CONTROL DEVICES SUCH AS SILT FENCING, SWALES, BERMS, GEOTEXTILES, SEDIMENT BASINS AND TRAPS. PROTECTION FOR STORM DRAIN INLETS SHALL BE PROVIDED TO PREVENT THE ENTRY OF SEDIMENT FROM THE SITE WHILE STILL ALLOWING THE ENTRY OF STORMWATER. CONTROL DEVICES SHALL BE KEPT IN PLACE AND USED UNTIL THE DISTURBED AREA IS PERMANENTLY STABILIZED.
6. THE CONTRACTOR SHALL NOT REMOVE SILT FENCE AND MULCH SOCKS OR OTHER TEMPORARY EROSION AND SEDIMENT CONTROL DEVICES UNTIL DISTURBED AREAS ARE STABILIZED. SOIL STABILIZATION AND EROSION CONTROL MEASURES SHALL BE COMPLETED WITHIN 21 CALENDAR DAYS AFTER COMPLETION OF CONSTRUCTION OR OTHER SOIL DISTURBANCE ACTIVITIES ON THE SITE. IF THE TIME OF YEAR IS NOT CONDUCIVE TO PLANTING, THEN PLANTING MAY BE DELAYED UNTIL THE NEXT APPROPRIATE PLANTING SEASON PROVIDED THAT ALL TEMPORARY EROSION CONTROL MEASURES ARE MAINTAINED UNTIL PERMANENT EROSION CONTROL MEASURES ARE IMPLEMENTED. TEMPORARY EROSION CONTROL MEASURES SHALL BE SELECTED, DESIGNED AND INSTALLED WITH AN APPROPRIATE SEED BASE TO PROVIDE EROSION CONTROL FOR AT LEAST THREE YEARS WITHOUT ACTIVE MAINTENANCE. TEMPORARY EROSION CONTROL MEASURES SHALL BE SELECTED, DESIGNED AND INSTALLED TO ACHIEVE 70 PERCENT VEGETATIVE COVER WITHIN THREE YEARS.

SWPP Plan Inspection Report

Project Name: _____

Purpose of Inspection: _____ Date: _____

Inspector: _____

Weather Information: Type, Time, Amount, and Duration of Each Storm Event since Last Inspection. List Dates and Location for Storm Events:

Location of NPDES Notice of Permit Coverage Posting: _____

Has Land Disturbance Log been maintained: [] Yes [] No [] N/A

Does the site map reflect current BMPs and Site Characteristics? [] Yes [] No

Does the site map reflect current BMPs and Site Characteristics? [] Yes [] No

Comments: _____

Evidence of Discharges of Sediment or other Pollutants from the Site (Describe Below): [] Yes [] No

Evidence of Spills or Leaks (Describe Below): [] Yes [] No

Evidence of Offsite Sediment Tracking (Describe Below): [] Yes [] No

Comments: _____

Is Facility in Compliance with SWPP Plan and Permit? [] Yes [] No

Incidents of Non-Compliance with SWPP Plan: _____

Land Disturbance Log, including Location and Date of Soil Disturbance, Activities and Stabilization Initiated:

SWPP Plan Inspection Report (Continued)

Certification Statement:

"I certify under penalty of law that this document and all attachments were prepared under my direction or supervision in accordance with a system designed to assure that qualified personnel properly gathered and evaluated the information submitted. Based on my inquiry of the person or persons who manage the system, or those persons directly responsible for gathering the information, the information submitted is, to the best of my knowledge and belief, true, accurate, and complete. I am aware that there are significant penalties for submitting false information, including the possibility of fine and imprisonment for knowing violations."

(Signature)

(Please Print Name, Title)

ENGINEERS SEAL				
	DATE			
REVISIONS				

CITY REVIEW		
DEPARTMENT	SIGN-OFF	DATE
WASTEWATER MANAGEMENT DIV.	SIGNATURE	ON FILE
WATER SERVICES		
STREETS DIV.		
TRAFFIC DIV.		
FIRE		
LANDSCAPE		
SUBDIVISION ENGINEER		
CITY	USE	ONLY

S
F
E
C

**Santa Fe Engineering
Consultants, LLC**

1599 St. Francis Drive, Suite B
Santa Fe, N. M. 87505
(505) 982-2845 Fax (505) 982-2641
<http://www.SFENGR.com>

ZOCALO - PHASE 5
SANTA FE, NEW MEXICO
INFRASTRUCTURE IMPROVEMENT PLANS
FOR POD B

STORM WATER CONTROL DETAILS

DATE: MAY 2020	SCALE: N.T.S.	SHEET: 14-4
-------------------	------------------	----------------

TEMPORARY EROSION & SEDIMENT CONTROL MEASURES (T.E.S.C.M.)

TYPICAL USAGE OF SELECTED EROSION AND SEDIMENT CONTROL MEASURES

STANDARD SYMBOLS FOR EROSION AND SEDIMENT CONTROL MEASURES

SILT FENCE	PIPE SLOPE DRAIN	SEDIMENT TRAP, BERM
STRAW BALES	DROP INLET PROTECTION	SEDIMENT TRAP, EXCAVATED
EARTH DIKE	CULVERT PROTECTION	SEDIMENT BASIN
DIVERSION CHANNEL (SWALE)	CHECK DAM	TRIANGULAR SEDIMENT FILTER DIKE

NO.	DATE	REV. BY	DESCRIPTION
NEW MEXICO DEPARTMENT OF TRANSPORTATION STANDARD DRAWING			
TEMPORARY EROSION & SEDIMENT CONTROL MEASURES			
APPROVED: <i>Raymundo Van Hoven</i> 11/29/10			
DESIGNED BY: _____ DRAWN BY: _____ CHECKED BY: _____			
603-01-1/7 SERIAL 1 OF 7			

GENERAL NOTES

- THE SOIL RETENTION BLANKET INSTALLATION DETAILS SHOWN FOR CULVERT PROTECTION SHALL BE USED FOR ALL TEMPORARY EROSION AND SEDIMENT CONTROL MEASURES UTILIZING SOIL RETENTION BLANKETS UNLESS OTHERWISE NOTED.
- ROCK PLATING USED IN THE TEMPORARY EROSION AND SEDIMENT CONTROL MEASURES SHOWN ON THESE SHEETS SHALL HAVE A MINIMUM THICKNESS OF 8 INCHES UNLESS OTHERWISE INDICATED.
- ALL TEMPORARY EROSION AND SEDIMENT CONTROL MEASURES PLACED WITHIN THE CONSTRUCTION CLEAR ZONE SHALL BE INSTALLED WITH 8:1 SLOPES PARALLEL TO TRAFFIC AND 4:1 SLOPES PERPENDICULAR TO TRAFFIC.
- SEDIMENT TRAPS SHALL BE CLEANED OF ACCUMULATED SEDIMENT WHEN APPROXIMATELY 50% FILLED.
- CHECK DAMS SHALL BE CLEANED OF ACCUMULATED SEDIMENT WHEN THE DEPOSITS REACH APPROXIMATELY ONE-HALF THE HEIGHT OF THE CHECK DAM.
- CULVERT PROTECTIONS SHALL BE INSTALLED UPON INITIATION OF EARTH WORK ACTIVITIES AND MAINTAINED AS MUCH AS PRACTICAL UNTIL STABILIZATION IS COMPLETED AND ACCEPTED. CULVERT PROTECTIONS MAY BE REMOVED FOR PERIODS OF TIME AS REQUIRED DURING CONSTRUCTION TO COMPLETE ADJACENT IMPROVEMENTS.
- THE CONTRACTOR MAY CONSTRUCT AN EARTH DIKE AS SHOWN, OR RELOCATE THE CHECK DAMS AS CONSTRUCTION PROGRESSES. NO DIRECT PAYMENT SHALL BE MADE FOR RELOCATION OF THE CHECK DAMS.
- STRAW BALES ARE NOT INTENDED FOR USE ON NEW MEXICO DEPARTMENT OF TRANSPORTATION PROJECTS.

TYPE III (STRAW BALE)

TYPE II STONE DAM

TYPE I SILT FENCE

NO.	DATE	REV. BY	DESCRIPTION
NEW MEXICO DEPARTMENT OF TRANSPORTATION STANDARD DRAWING			
TEMPORARY EROSION & SEDIMENT CONTROL MEASURES			
CHECK DAMS			
APPROVED: <i>Raymundo Van Hoven</i> 11/29/10			
DESIGNED BY: _____ DRAWN BY: _____ CHECKED BY: _____			
603-01-2/7 SHEET 2 OF 7			

TYPE II STRAW BALE OPTION

TYPE I SILT FENCE

NOTES: SILT FENCE AND CHECK DAM

THE CONTRACTOR SHALL BE RESPONSIBLE FOR DETERMINING THE POST SPACING FOR SILT FENCES TO MINIMIZE MAINTENANCE.

- POST SPACING SHALL BE 4 FT. MAXIMUM WITHOUT SUPPORTING FENCE. 10 FT. MAXIMUM WITH SUPPORTING FENCE.
- POSTS FOR 4 FT. MAXIMUM POST SPACING SHALL BE 2 INCH SQUARE NOMINAL SIZE OR HEAVIER WOOD POSTS, OR STANDARD "T" OR "U" SECTION STEEL POSTS WEIGHING NOT LESS THAN 2 LBS. PER LINEAR FOOT.
- POSTS FOR 10 FT. MAXIMUM POST SPACING SHALL BE 4 INCH SQUARE NOMINAL SIZE OR HEAVIER WOOD POSTS, OR STEEL POSTS AS SPECIFIED ABOVE.
- SUPPORTING FENCE SHALL BE WIRE MESH (14 GA. MIN., 1 INCH MAX. MESH OPENINGS), SNOW FENCE, PLASTIC FENCE OR APPROVED.
- SUPPORTING FENCE SHALL BE FASTENED SECURELY TO POSTS WITH STAPLES OR WIRE TIES. GEOTEXTILE FABRIC SHALL BE FASTENED SECURELY TO SUPPORTING FENCE WITH WIRE TIES SPACED AT 2 FT. CENTERS ALONG THE TOP AND MID-SECTION. WHEN A SUPPORTING FENCE IS NOT USED, GEOTEXTILE FABRIC SHALL BE SECURELY FASTENED TO POSTS WITH STAPLES OR WIRE TIES.
- WHEN SILT FENCE IS USED FOR CHECK DAMS INSTALLED IN DITCHES, A SUPPORTING FENCE SHALL BE PROVIDED, WITH MAXIMUM POST SPACING OF 10 FT.
- STANDARD "T" OR "U" SECTION STEEL POSTS SHALL NOT BE USED WITHIN THE CONSTRUCTION CLEAR ZONE RECOVERY AREA.
- STRAW BALES ARE NOT INTENDED FOR USE ON NEW MEXICO DEPARTMENT OF TRANSPORTATION PROJECTS.

NO.	DATE	REV. BY	DESCRIPTION
NEW MEXICO DEPARTMENT OF TRANSPORTATION STANDARD DRAWING			
TEMPORARY EROSION & SEDIMENT CONTROL MEASURES			
SILT FENCE			
APPROVED: <i>Raymundo Van Hoven</i> 11/29/10			
DESIGNED BY: _____ DRAWN BY: _____ CHECKED BY: _____			
603-01-3/7			

TYPICAL DITCH LINER INSTALLATIONS AT CULVERTS

TYPE I CURB OPENING

TYPE II CURB DROP INLET

NOTES: CULVERT PROTECTION

- WHEN CULVERT PROTECTION IS SPECIFIED, EITHER SOIL RETENTION BLANKETS OR SOIL RETENTION ROCK MAY BE PROVIDED.
- THE CULVERT PROTECTION WIDTH REQUIRED SHALL BE IN ACCORDANCE WITH THESE DETAILS UNLESS SPECIFIED OTHERWISE.
- THE SOIL RETENTION BLANKET INSTALLATION SHOWN OUTLINES MINIMUM REQUIREMENTS. MANUFACTURER'S RECOMMENDATIONS SHALL BE USED IF THEY ARE MORE STRINGENT.

NO.	DATE	REV. BY	DESCRIPTION
NEW MEXICO DEPARTMENT OF TRANSPORTATION STANDARD DRAWING			
TEMPORARY EROSION & SEDIMENT CONTROL MEASURES			
CULVERT & DROP INLET PROTECTION			
APPROVED: <i>Raymundo Van Hoven</i> 11/29/10			
DESIGNED BY: _____ DRAWN BY: _____ CHECKED BY: _____			
603-01-4/7			